



Doncaster, VIC

2 Makybe Walk

4 BED 2 BATH 2 CAR 

Premium Townhome in the Heart of Tullamore offers park views

An exceptional example of the sustainable lifestyle Tullamore offers, this multi-level abode adorns premium fixtures and fittings with a thoughtful and practical floorplan sure to please both families and empty-nester's alike.

Townhome Features:

- Spacious open plan living and dining area flowing to park front courtyard
- Gourmet kitchen with large island bench for extra storage solutions, an entertainers delight!
- Generous courtyard offering tranquil parkland views
- Ground level powder room for added convenience
- Grand master suite features park views, dual vanity and built-in robe

\$1,100 per week

View: Thu, 9 May 2024 @5:00 pm - 5:20 pm

Contact: Aleiasha Clark
03 9645 1199
0491 174 507

Type: House

Date Available: 14/05/2024

<https://www.resbymirvac.com>

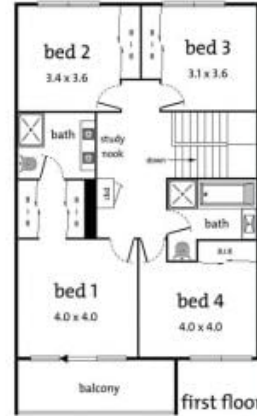
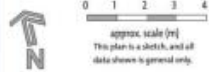
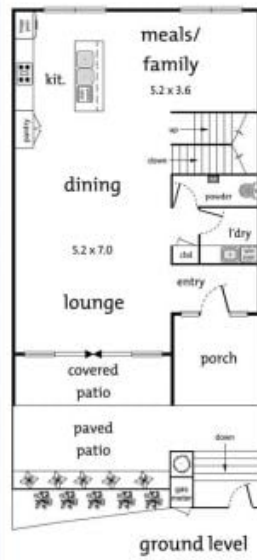

Plans shown are only indicative of layout. Dimensions are approximate.

Doncaster, VIC
2 Makybe Walk