

## Sydney Olympic Park, NSW

21607/2 Figtree Drive

**1**  
BED

**1**  
BATH



### Furnished 1 Bedroom Apartment in 'Pavilions', Sydney Olympic Park

Welcome to Pavilions in Sydney Olympic Park

Discover the unparalleled allure of Sydney Olympic Park, where Pavilions by Mirvac offers a lifestyle of convenience and luxury. Nestled amidst vibrant parklands, trendy cafes, and world-class sporting facilities, residents enjoy proximity to an array of amenities. As a resident of Pavilions by Mirvac, you'll have exclusive access to a gym, co-working space, and a dedicated children's play area, ensuring every aspect of your lifestyle is catered to with style and sophistication.

This spacious 63sqm apartment features:

### Deposit Taken! Inspection Canceled!

**Contact:** Renee Zhang  
02 8588 8888  
0481 440 088

**Type:** Apartment

**Date Available:** 21/05/2023

<https://www.resbymirvac.com>

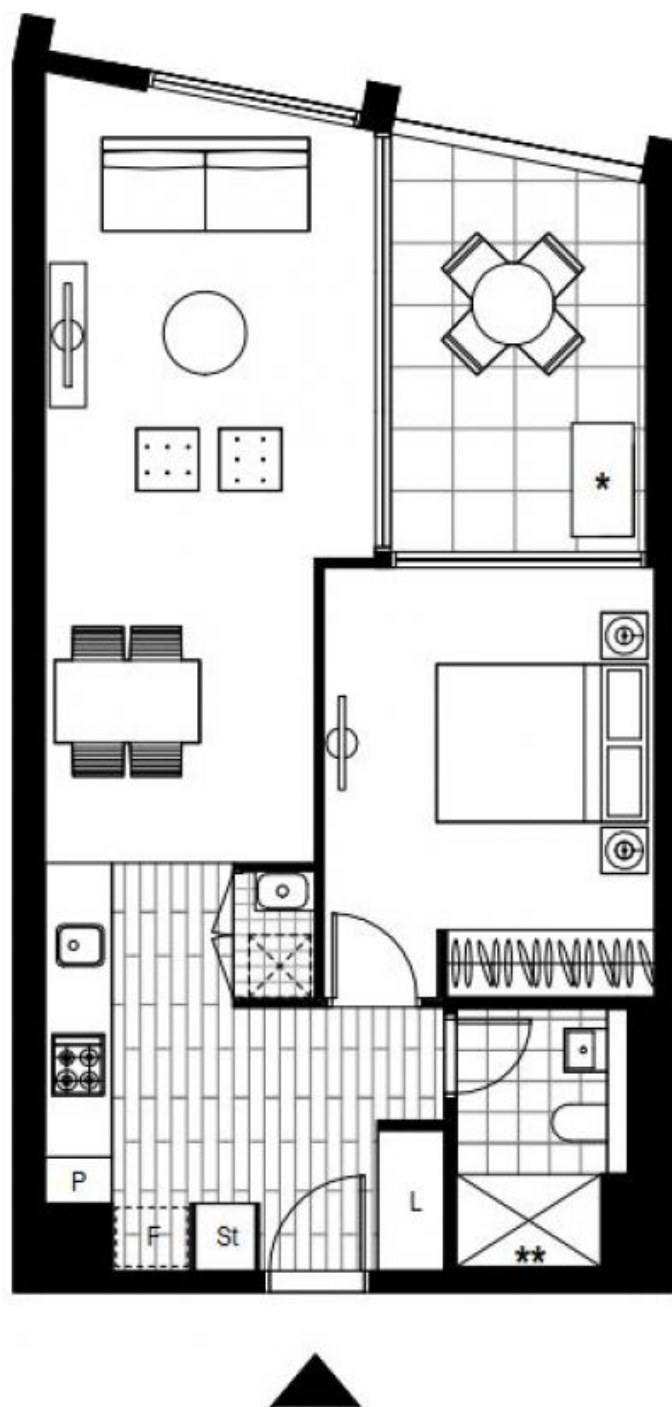

Plans shown are only indicative of layout. Dimensions are approximate.

**Sydney Olympic Park, NSW**  
21607/2 Figtree Drive