



## Docklands, VIC

3003/103 South Wharf Drive

**2** **2** **1**   
BED BATH CAR

### Community-focused living in the waterfront Mirvac-built Yarra's Edge

A revelation of style, quality and lifestyle excellence unfolds with perfect poise in this luxury 'Voyager' apartment in the waterfront Mirvac-developed Yarra's Edge precinct. It offers space, elegance and views without compromise, including an open plan indoor/outdoor design, fine finishes and inclusions and a Yarra River and city skyline outlook that dazzles day and night. A home that will delight executive couples, young families and vibrant downsizers alike, it's community-oriented and promotes an active and social lifestyle.

#### Apartment Features:

- Impeccable views of the city skyline and Yarra River
- Entertainers kitchen with extensive storage and island bench

**\$820 per week**

**Contact:** Aleiasha Clark  
03 9645 1199  
0491 174 507

**Type:** Apartment

**Date Available:** 21/05/2024

**<https://www.resbymirvac.com>**

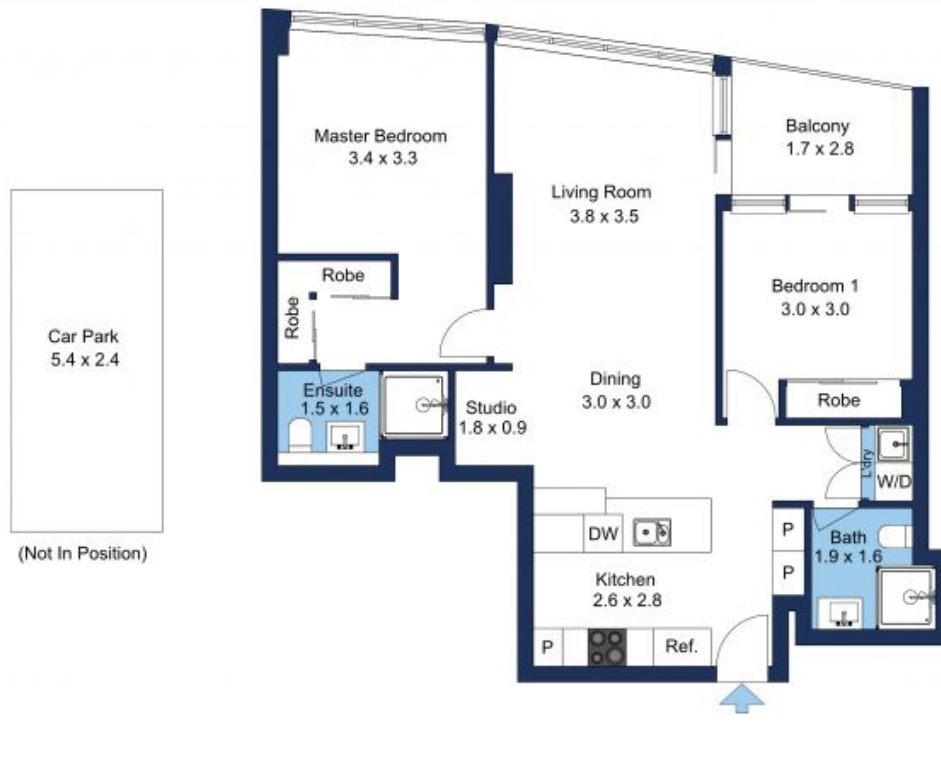

The floor plan is not to scale; measurements are indicative and in metres. Exterior elements are not in position. Plans should not be relied on. Interested parties should make and rely on their own enquiries.

Plans shown are only indicative of layout. Dimensions are approximate.

**Docklands, VIC**  
3003/103 South Wharf Drive