



## Glebe, NSW

8/1a The Crescent

**1**  
BED

**1**  
BATH



### Modern 1 Bedroom Courtyard Apartment in Mirvac's Harold Park

Welcome to Harold Park, Glebe's Secret Backyard.

Here in Harold Park you will find yourself in an idyllic parkside location, with only a short walk to Glebe Foreshore. Just meters away, The Tramsheds retail precinct resides featuring cafes, a grocery store, restaurants and a medical centre.

This 62sqm, 1-bedroom apartment features:

- Spacious bedroom with generous built-in wardrobes
- Open-plan living and dining area, leading to the balcony
- Contemporary kitchen with stone benchtop and Miele appliances

**\$780 per week | Deposit Taken!**

**Contact:** Georgia Glynn  
02 8588 8888  
0481 388 777

**Type:** Apartment

**Date Available:** 07/02/2024

**Bond:** \$3120

<https://www.resbymirvac.com>

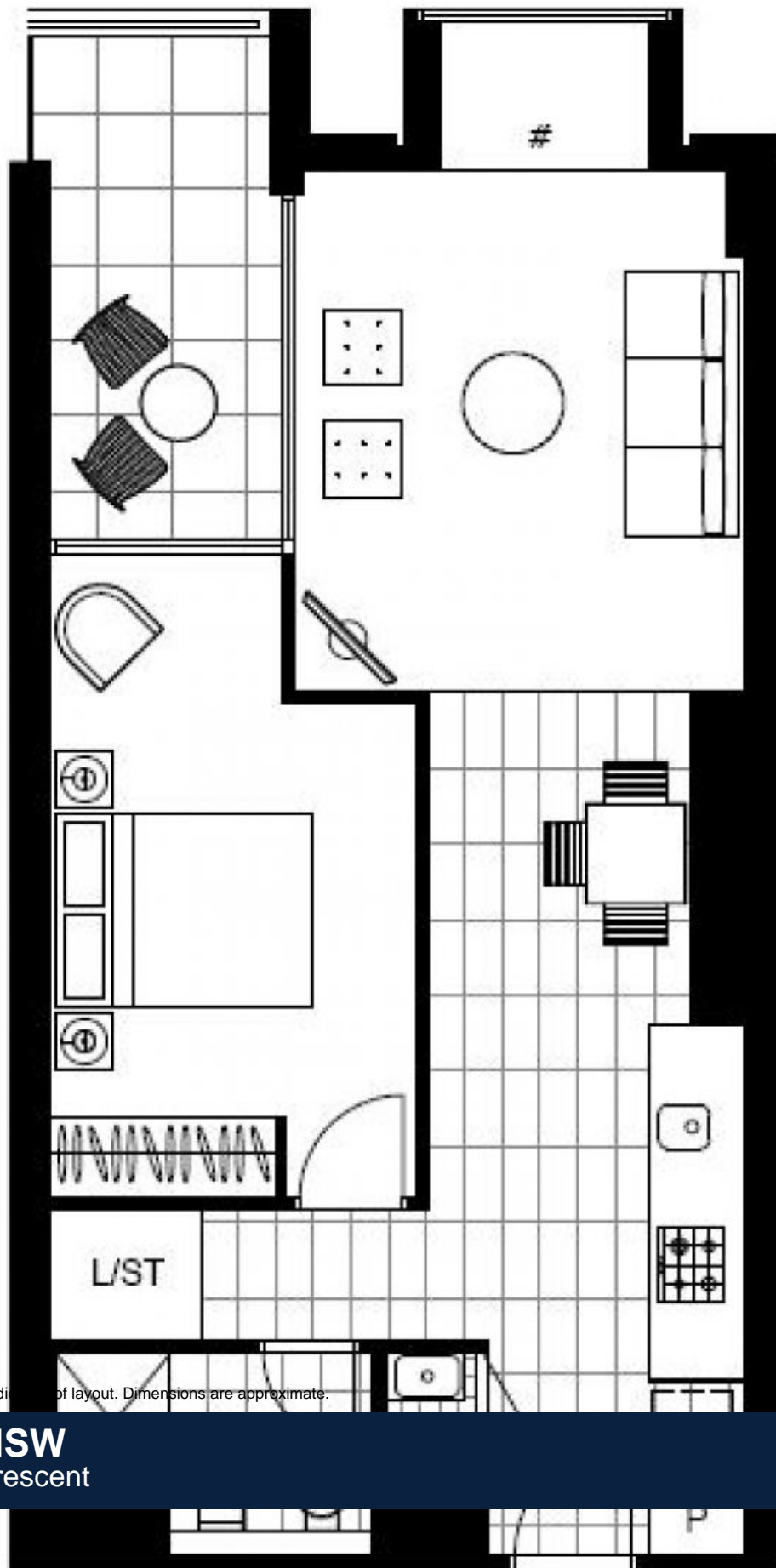

Plans shown are only indicative of layout. Dimensions are approximate.

**Glebe, NSW**  
8/1a The Crescent