



**Docklands, VIC**  
1308/60 Lorimer Street

**1** BED   **1** BATH   **1** CAR



**Spacious 1B Apartment with bay views to begin your Yarra's Edge Living**

Situated on the 13th level of the highly sought-after Tower 2 in the wonderful Yarra's Edge, this remarkable one-bedroom apartment offers unparalleled views that demand inspection.

- Open plan living & dining with floorboards throughout
- Spacious bedroom, complete with walk-in robe, double glazed windows and sliding door to balcony
- Renovated gourmet kitchen featuring generous storage space, stainless steel appliances and large island bench
- Expansive outdoor balcony perfect for relaxation and entertaining, providing panoramic views across Port Phillip Bay
- Central contemporary bathroom

**\$515,000**

**Council Rates:** \$1,200/year (approx)

**Contact:** Andrew Chen  
03 9645 1199  
0490 816 861  
Andrew Chen  
03 9645 1199  
0490 816 861

**Type:** Apartment

**Sold Date:** 26/01/2024

**<https://www.resbymirvac.com>**

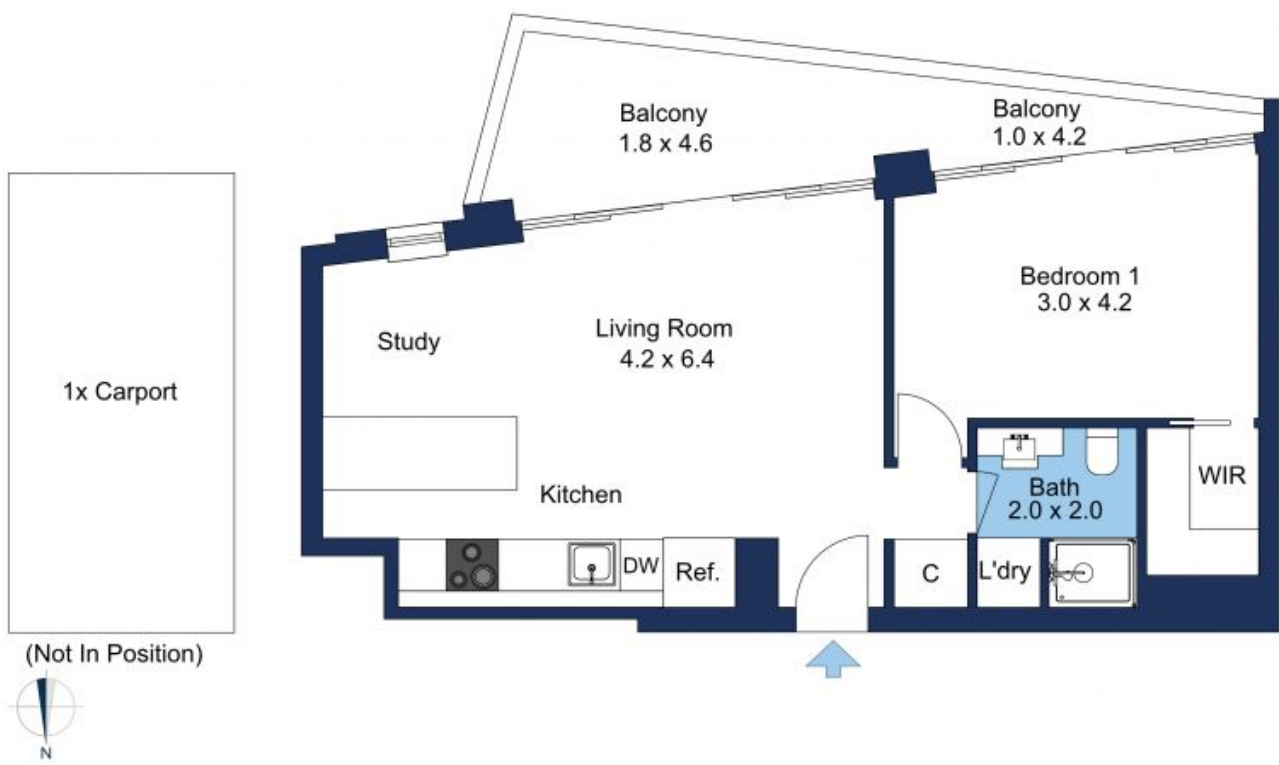

The floor plan is not to scale; measurements are indicative and in metres. Exterior elements are not in position. Plans should not be relied on. Interested parties should make and rely on their own enquiries.

Plans shown are only indicative of layout. Dimensions are approximate.

**Docklands, VIC**  
1308/60 Lorimer Street