



Docklands, VIC
1105/81 South Wharf Drive

2 BED **2** BATH **1** CAR



North-Facing Forge Oasis is a Stylish Standout

With an enviable northerly aspect that allows for truly special views of the memorable city skyline, this two-bedroom with two-bathroom apartment in the Forge complex is one of the best opportunities in the Yarras Edge precinct. With contemporary grace and a considered floorplan which makes the most of the space and views, this 11th floor apartment will have widespread appeal.

- Sizeable open lounge and dining, stone kitchen, added island bench, pendant lights, elegant cabinetry and SMEG appliances
- Three access points to balcony with panoramic CBD, Yarra River views
- Two bedrooms with BIR, master with ensuite, floor-to-ceiling windows
- North facing lighting, ducted heating and cooling, concealed laundry
- Motorised blinds in living room and bedrooms

\$708,000

Council Rates: \$1,300/year (approx)

Contact: Andrew Chen
03 9645 1199
0490 816 861
Andrew Chen
03 9645 1199
0490 816 861

Type: Apartment

Sold Date: 08/07/2023

<https://www.resbymirvac.com>

Floor Plan

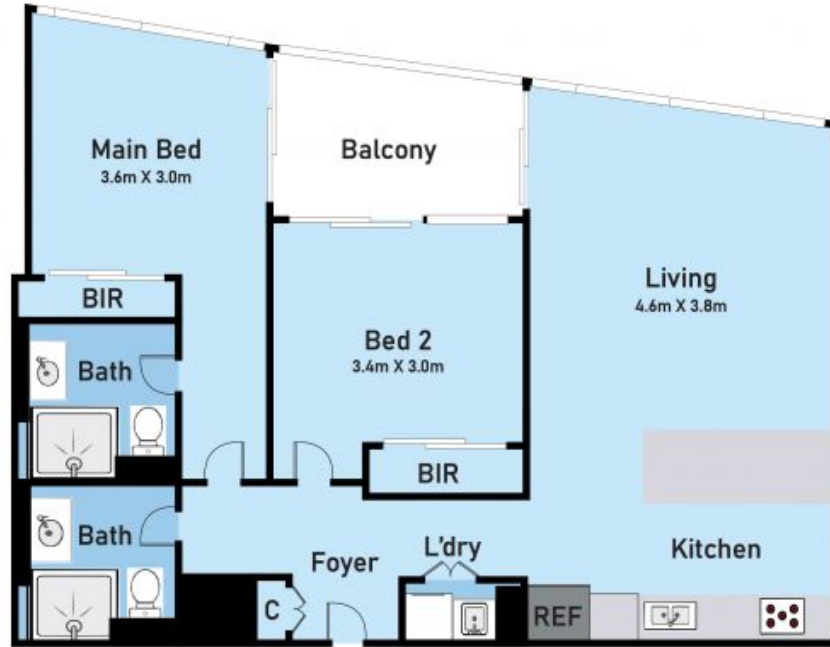

1105/81 South Wharf Drive, Docklands

* Dimensions are approximate and for illustrative purposes only

Plans shown are only indicative of layout. Dimensions are approximate.

Docklands, VIC
1105/81 South Wharf Drive