



Docklands, VIC

3302/100 Lorimer Street

2
BED

2
BATH

2
CAR



'YARRA'S EDGE' SENSATION NEXT TO POINT PARK

Perfectly positioned next to gorgeous Point Park in the coveted 'Yarra's Edge' development, this apartment is a showpiece of contemporary-style magnificence. Gazing out over the Yarra River to Docklands and the city skyline, it maximises this spectacular outlook and sunny northwest aspect with floor-to-ceiling windows and a full-width balcony. Enjoy seamless indoor/outdoor living from the open plan entertaining space, both bedrooms and the study. Exuding a sense of understated elegance, only the sleekest finishes have been selected to appoint the roomy interiors. Part of a lively waterfront community, step out to walks, eateries and a dog park and keep in shape with your complimentary RekDek membership.

? Open plan kitchen and superbly generous living/dining area

Contact agent

Council Rates: \$2,400/year (approx)

Contact: Andrew Chen
03 9645 1199
0490 816 861
Andrew Chen
03 9645 1199
0490 816 861

Type: Apartment

Sold Date: 17/02/2023

<https://www.resbymirvac.com>



2 2 2



LOCATION
PLAN

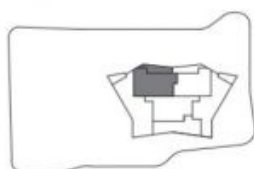

LEVEL 33

INTERNAL: 115m²
BALCONY: 23m²
CARSPACE: 2
STUDY ROOM: Yes
STORAGE CAGE: 1
AMENITY: RekDek Facilities

Please note that this floor plan is a guide only.
The information contained herein is not
guaranteed. Dimensions are approximate.
Prospective purchasers must rely on their own
enquiries.



real estate
services
by mirvac

3302/100 Lorimer Street

DOCKLANDS

Plans shown are only indicative of layout. Dimensions are approximate.

Docklands, VIC
3302/100 Lorimer Street