



Glebe, NSW

115/1A The Crescent

1
BED

1
BATH



Modern 1-Bedroom Apartment in Harold Park

Welcome to Harold Park, Glebe's Secret Backyard.

Here in Harold Park you will find yourself in an idyllic park side location, with only a short walk to Glebe Foreshore. Just meters away, The Tramsheds retail precinct resides featuring cafes, a grocery store, restaurants and a medical centre.

This 60sqm one bedroom apartment features:

- Well-appointed bedroom with generous built-in wardrobe
- Carpeted living area, leading to private balcony
- Contemporary kitchen with stone benchtop and Miele appliances
- Modern bathroom with plenty of storage

\$640 per week | Deposit Taken

Contact: Naz Sabzpouri
02 8588 8888
0401 545 440

Type: Apartment
Date Available: 04/11/2020

Bond: \$2560

<https://www.resbymirvac.com>

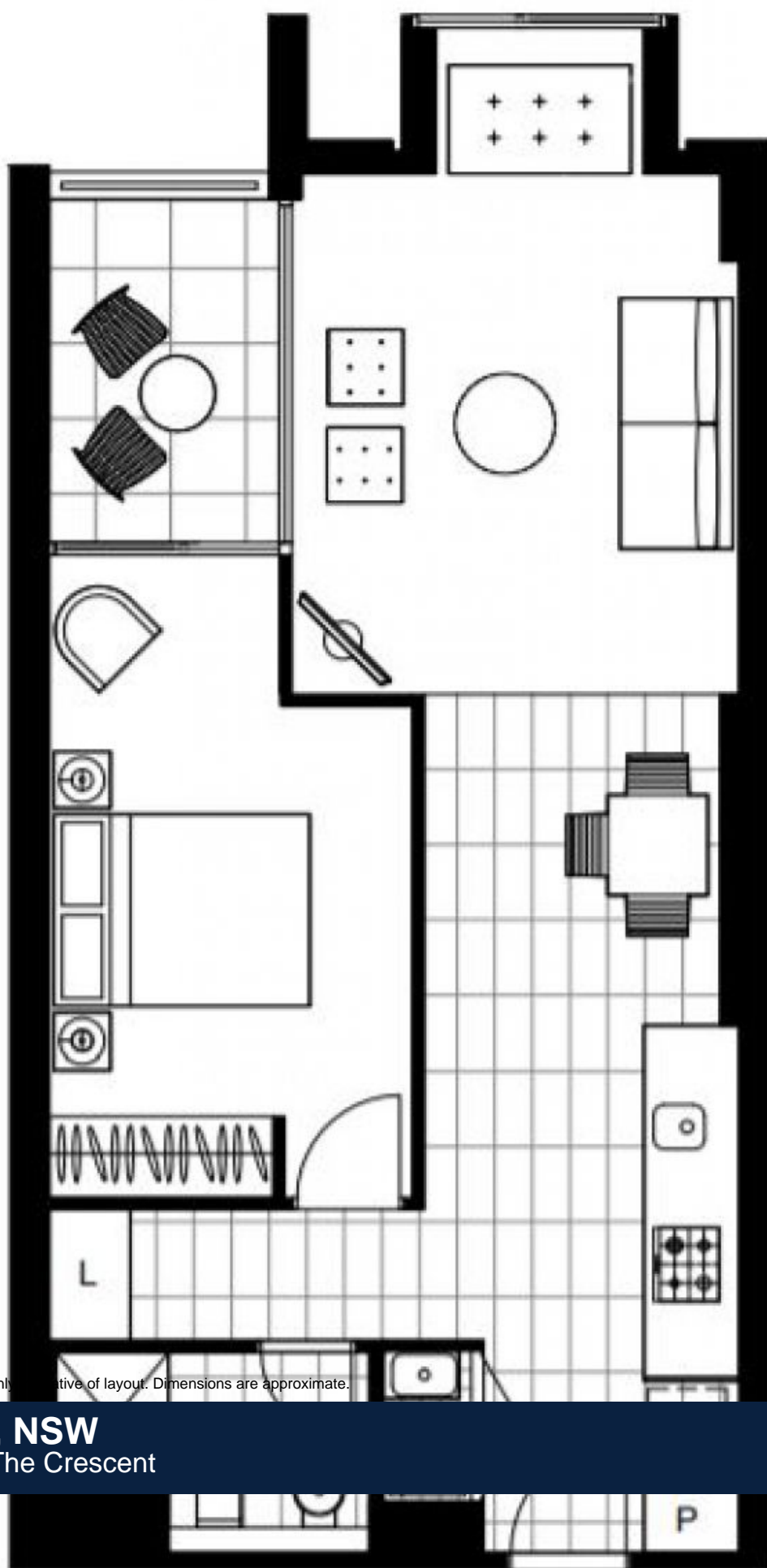

Plans shown are only illustrative of layout. Dimensions are approximate.

Glebe, NSW
115/1A The Crescent