



## Glebe, NSW

115/1A The Crescent

**1**  
BED

**1**  
BATH



### Modern 1-Bedroom Apartment in Harold Park

Welcome to Harold Park, Glebe's Secret Backyard.

Here in Harold Park you will find yourself in an idyllic park side location, with only a short walk to Glebe Foreshore. Just meters away, The Tramsheds retail precinct resides featuring cafes, a grocery store, restaurants and a medical centre.

This 60sqm one bedroom apartment features:

- Well-appointed bedroom with generous built-in wardrobe
- Carpeted living area, leading to private balcony
- Contemporary kitchen with stone benchtop and Miele appliances
- Modern bathroom with plenty of storage

**\$640 per week | Deposit Taken**

**Contact:** Naz Sabzpouri  
02 8588 8888  
0401 545 440

**Type:** Apartment  
**Date Available:** 04/11/2020

**Bond:** \$2560

<https://www.resbymirvac.com>

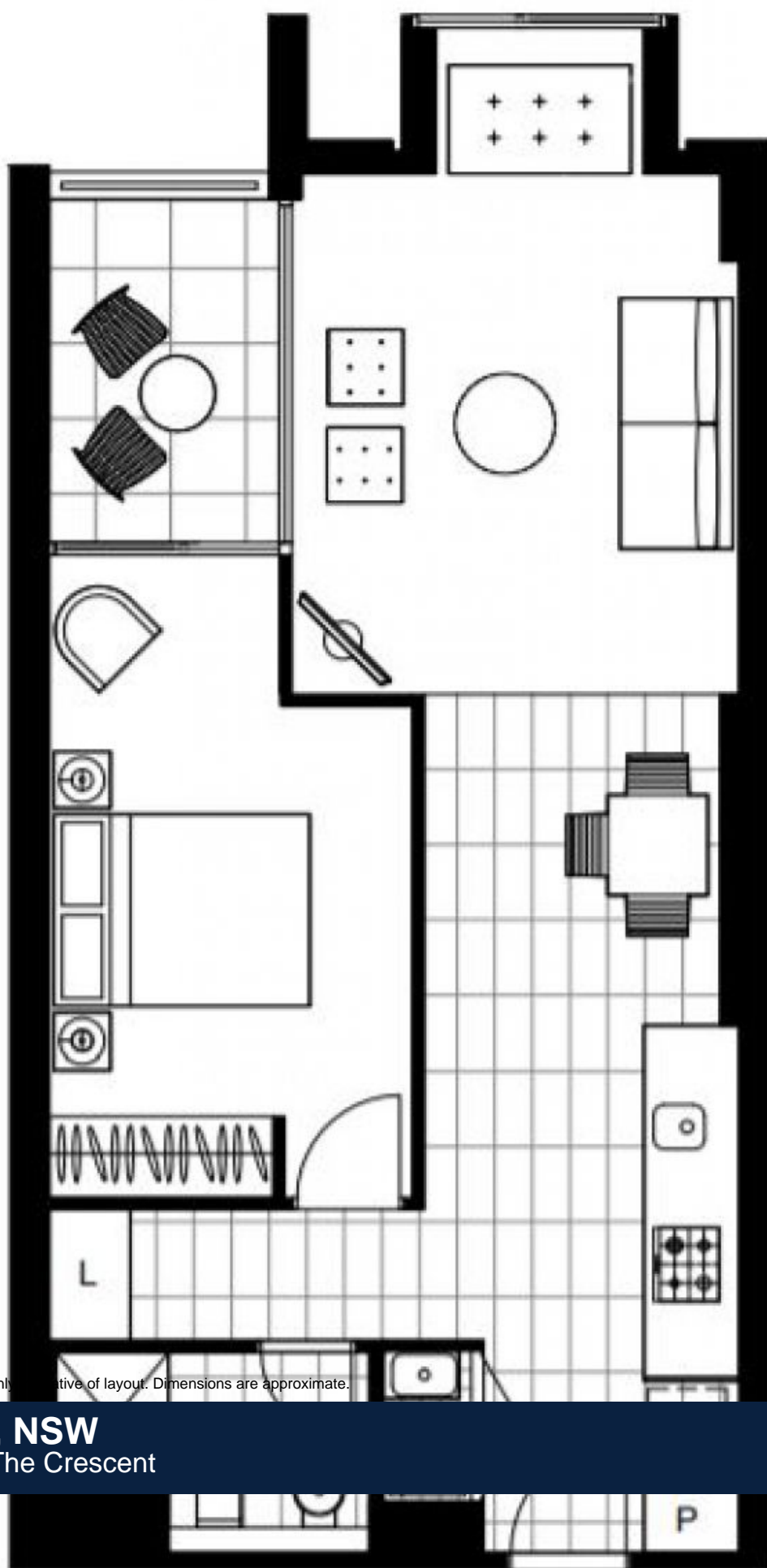

Plans shown are only illustrative of layout. Dimensions are approximate.

**Glebe, NSW**  
115/1A The Crescent