



## East Melbourne, VIC

1018/280 Albert Street

**3** BED **2** BATH **3** CAR 

### Bespoke luxury and style at The Eastbourne

Welcome to 'The Eastbourne', Melbourne's exclusive inner city Eden.

Mirvac's Flagship development designed by Award-Winning Architects Bates & Smart, located in East Melbourne. A neighbourhood of distinction, steeped in history and home to a privileged few.

The exceptional 3 Bedroom, 2 Bath, 3 Car Garage apartment features;  
 Expansive views of the Fitzroy Gardens and city  
 Well-appointed kitchen with large island bench  
 European appliances  
 Scullery with wine fridge & zip/zap tap and Integrated Fridge/Freezer  
 Separate laundry with ASKO drying cabinet  
 Exclusive access to the master club and cellar

### UNDER OFFER | PENDING DEPOSIT

**Contact:** Aleiasha Clark  
 03 9645 1199  
 0491 174 507

**Type:** Apartment

**Date Available:** 31/10/2022

**<https://www.resbymirvac.com>**

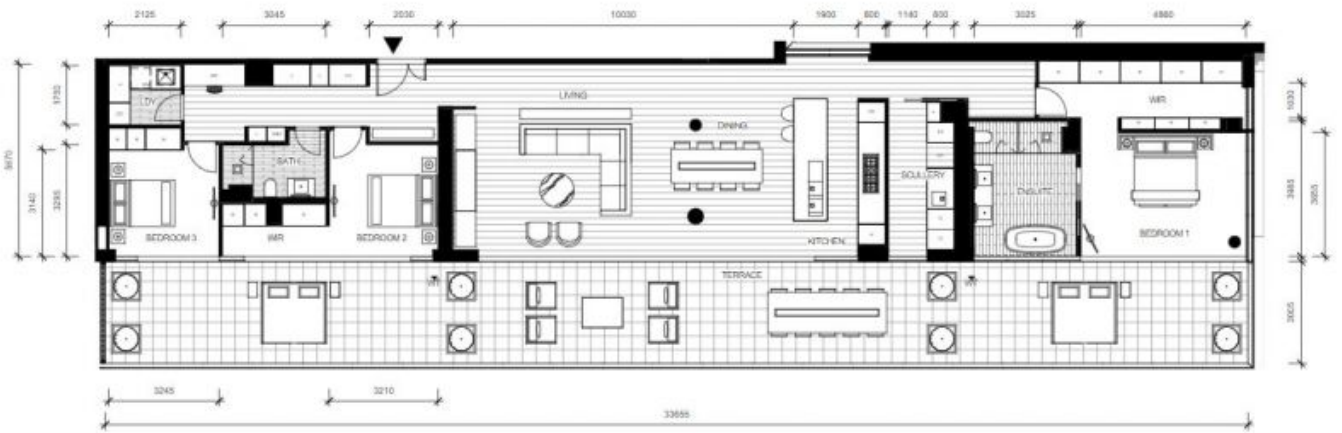

Plans shown are only indicative of layout. Dimensions are approximate.

**East Melbourne, VIC**  
 1018/280 Albert Street