



## Docklands, VIC

2906/81 South Wharf Drive

**1** BED **1** BATH **1** CAR



### A lifestyle approach with 1-bedroom and bay views

Expansive one-bedroom apartment with winter garden will impress lovers of Docklands, Yarras Edge. An exciting open plan living and kitchen area offering one of the best 1-bedroom floorplans South Wharf Drive has!

- Open plan living with natural light throughout
- Kitchen area with Smeg appliances and dark toned splashback
- Perfectly positioned winter garden, south-east-facing bay views
- Bathroom with highly detailed lighting throughout, light scheme
- Large bedroom with extra extension for built-in-robe
- Secure intercom and secure car space with storage
- Ducted heating and cooling throughout
- Access to Wharfs Club inclusive of gym, pool, steam room & sauna
- Stroll to South Wharf DFO, eateries, bars, waterside cafe's

**\$475,000**

**Council Rates:** \$1,100/year (approx)

**Contact:** Andrew Chen  
03 9645 1199  
0490 816 861  
Andrew Chen  
03 9645 1199  
0490 816 861

**Type:** Apartment

**Sold Date:** 22/07/2023

<https://www.resbymirvac.com>

# 2906/81 SOUTH WHARF DRIVE, DOCKLANDS

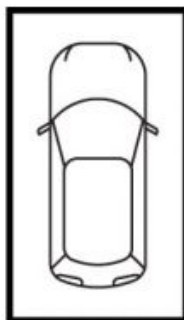
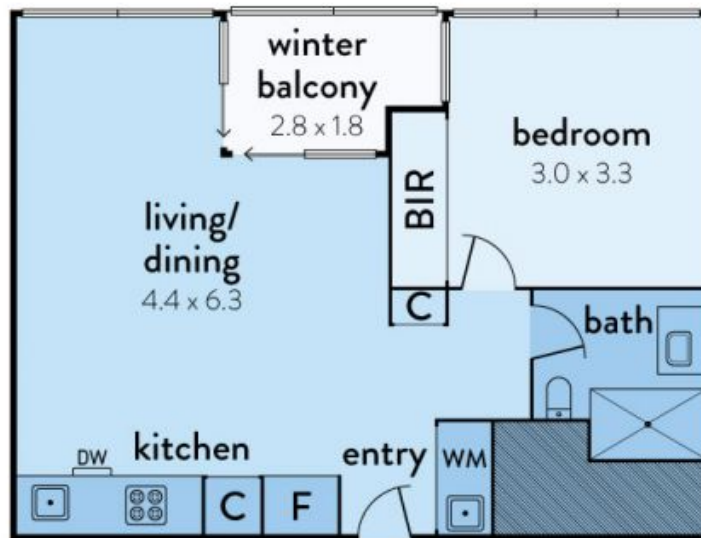

**carspace**  
(not in position)



(not in position)



**real estate  
services**  
by mirvac

Plans shown are only indicative of layout. Dimensions are approximate.

The above plan is an artist's impression only, it includes elements that are for display purposes and may not be to scale. Dimensions are approximate and every care has been taken to verify the accuracy of details.

**Docklands, VIC**  
2906/81 South Wharf Drive