



## Docklands, VIC

2202/81 South Wharf Drive

**2**  
BED

**1**  
BATH

**1**  
CAR



### Stunning marina views meets enviable Forge luxury

Set on the 22nd floor of Forge Apartments, this luxurious and light-filled 2-bedroom apartment promises timeless contemporary living with north-west marina and city views that are unforgettable!

North-West light flows through generously sized living and dining zone  
Hidden balcony offering sensational views of the marina and more  
Stone kitchen, breakfast bar, mirrored splashback, black tapware  
Stainless steel Smeg appliances  
Bedrooms with built-in robes, one bedroom with direct balcony access  
Designer detailed bathroom and smart living European laundry facilities  
Ducted heating & cooling, secure intercom and secure car space  
Access to Wharfs Club with gym, pool, cafe, kitchen/dining and cinema  
Skip to IGA supermarket, South Wharf DFO, Promenade restaurants, bars and cafes at arms-reach and easy access for Southern Cross Station and free city trams

### Contact Agent

**Council Rates:** \$1,685/year (approx)

**Contact:** Andrew Chen  
03 9645 1199  
0490 816 861

**Type:** Apartment

<https://www.resbymirvac.com>

# 2202/81 SOUTH WHARF DRIVE, DOCKLANDS

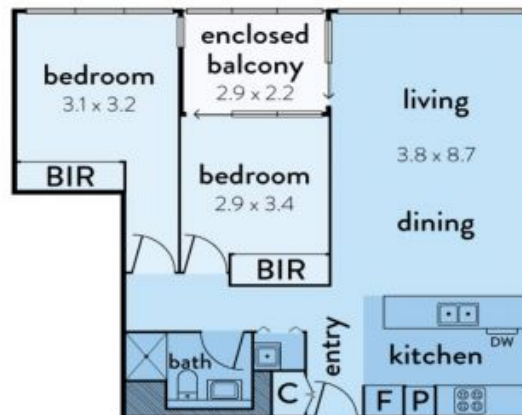

This floorplan is an artist's impression only, it contains information that we believe to be reliable however we cannot guarantee and accept no responsibility for the accuracy of information supplied. All dimensions are indicative and listed in metres. Interested parties should take their own measurements or engage the services of a licensed surveyor.

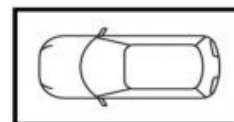

**carspace**  
(not in position)



Plans shown are only indicative of layout. Dimensions are approximate.

**Docklands, VIC**  
2202/81 South Wharf Drive