



Docklands, VIC

1002/81 South Wharf Drive

2 BED **1** BATH **1** CAR



River side luxury offers stunning marina views in Forge!

Forge - Melbourne's luxury waterfront address. Enjoy this two-bedroom apartment in the prestigious Yarras Edge precinct will be like no other. This luxurious and light-filled 2-bedroom apartment promises timeless contemporary living with north-west marina and city views that are unforgettable!

Beautiful north-west light, generous dining and double living zone
Private winter garden balcony, sensational views of the marina, Victoria Harbour and city
Stone-kitchen, mirrored splashback, black tapware and stainless steel Smeg appliances
Ducted heating and cooling, double glazed windows and floorplan to entertain

Contact agent

Council Rates: \$1,524/year (approx)

Contact: Andrew Chen
03 9645 1199
0490 816 861
Andrew Chen
03 9645 1199
0490 816 861

Type: Apartment

Sold Date: 27/02/2023

<https://www.resbymirvac.com>

1002/81 SOUTH WHARF DRIVE, DOCKLANDS

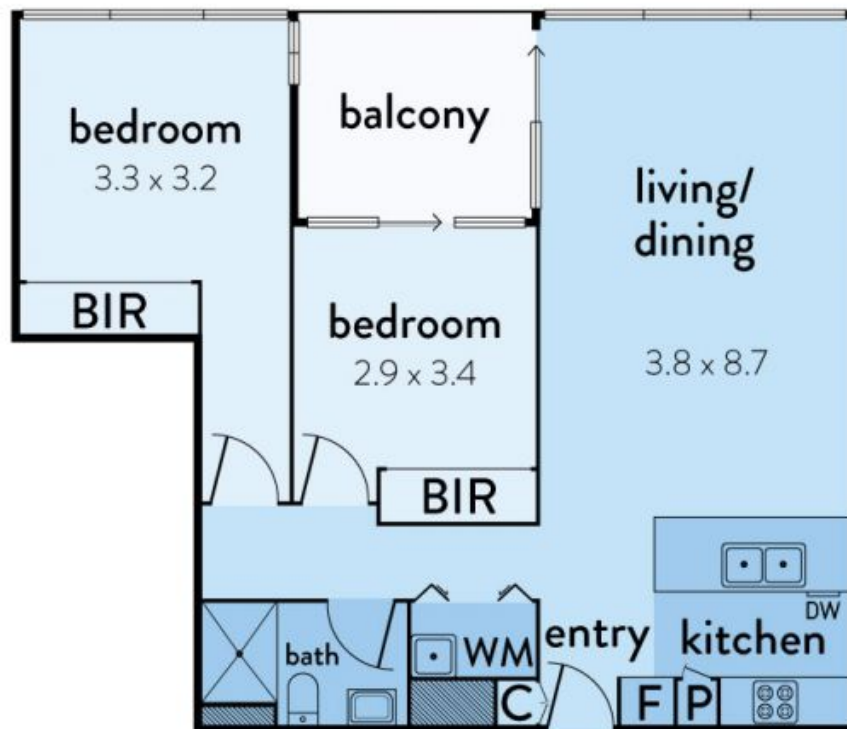

real estate
services
by mirvac

Plans shown are only indicative of layout. Dimensions are approximate.

The above plan is an artist's impression only, it includes elements that are for display purposes and may not be to scale. Dimensions are approximate and every care has been taken to verify the accuracy of details.

Docklands, VIC
1002/81 South Wharf Drive