

DOCKLANDS, VIC
1601/60 Lorimer Street

2 BED **2** BATH **2** CAR



Never tire of the Yarra River views and elite luxury
Wake up to exceptional views down the Yarra River and amidst modern class and relaxed surrounds with this unbelievable 2-bedroom + study, 2-bathroom, 2-car space apartment. In the coveted Yarra's Edge complex, this 'Tower 2' abode impresses with a wonderful amount of space inside and out, along with access to the famed 'RekDek'.

\$990,000-\$1,030,000
Contact: Andrew Chen
Type: Apartment
Sold Date: 04/08/2022
<https://www.resbymirvac.com>

- ? Take advantage of 116 sqm (approx.) combined internal and external
- ? Open plan living zone with plenty of room, dedicated lounge and dining areas
- ? Balcony across living, dining zone and master bedroom
- ? Stunning views of the Yarra River with Docklands Park in the distance
- ? Sleek kitchen with black motif, handy island bench, stainless steel appliances

1601/60 LORIMER STREET DOCKLANDS

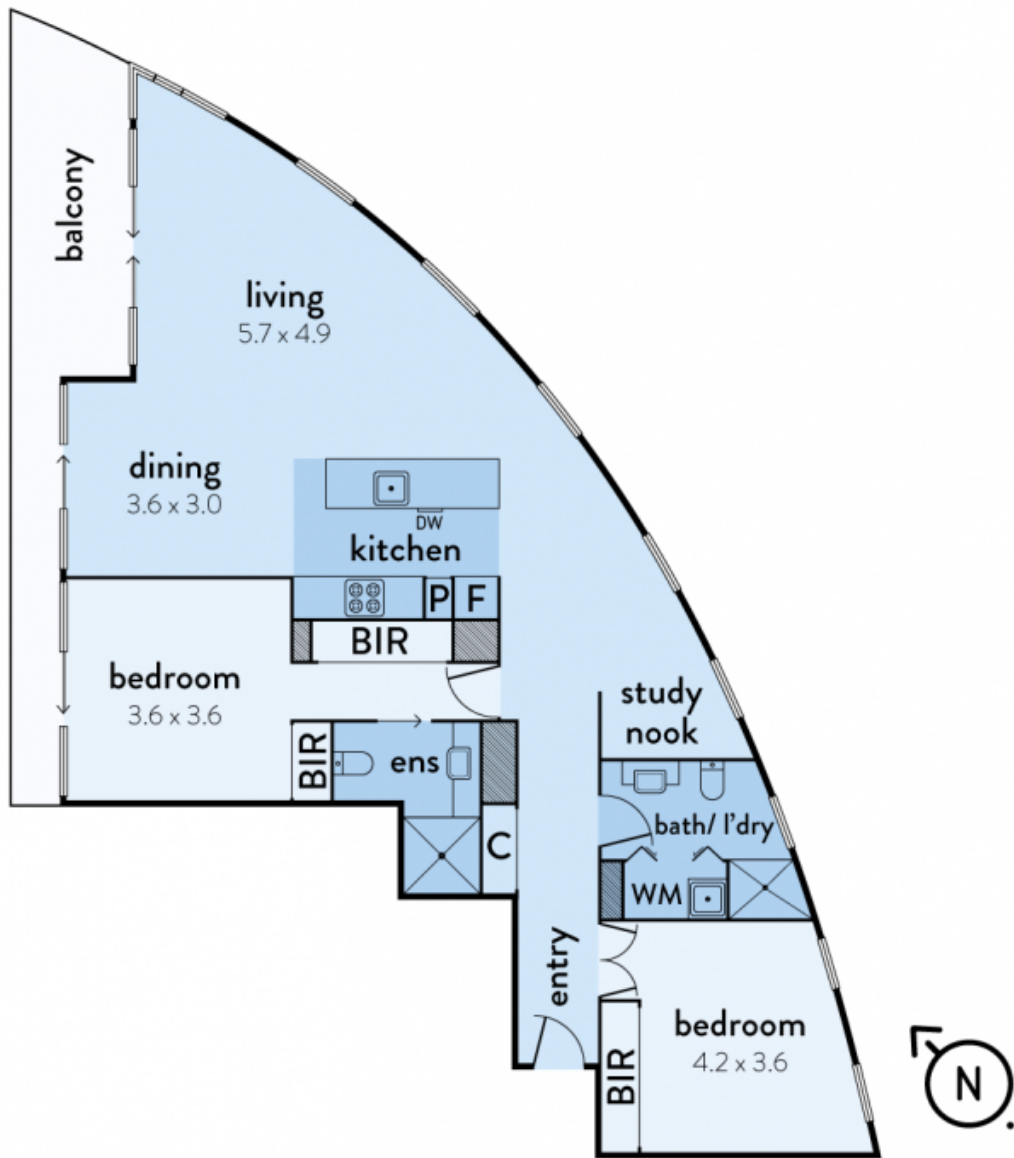

Plans shown are only indicative of layout. Dimensions are approximate.

The above plan is an artist's impression only, it includes elements that are for display purposes and may not be to scale. Dimensions are approximate and every care has been taken to verify the accuracy of details.

DOCKLANDS, VIC
1601/60 Lorimer Street