



**St Leonards, NSW**  
705/486 Pacific Highway

**2** BED   **2** BATH   **1** CAR



**Space, light and luxury in desirable new resort-style complex**

Gazing out over treetops and rooftops through floor-to-ceiling glass windows, this luxurious sky-home is part of the divine 'St Leonards Square' complex. It boasts generous proportions, open plan indoor/outdoor entertaining and only the finest finishes and inclusions. The building's indoor lap pool, gym, spa and sauna makes keeping in shape a breeze.

- ? Spacious living/dining room flows to entertaining terrace
- ? Stone kitchen, gas stainless steel Miele cooking, dishwasher
- ? Generous bedrooms with built-in robes, one with an ensuite
- ? Stylish fully tiled bathrooms, internal laundry, air conditioning
- ? Security entrance, lift access, underground parking, storage

**Sold \$1,380,000**

**Council Rates:** \$352/qtr (approx)  
**Strata Rates:** \$1,580/qtr (approx)  
**Contact:** William Kwok  
 0285888888  
 0481 702 370  
 William Kwok  
 0285888888  
 0481 702 370

**Type:** Apartment  
**Sold Date:** 02/05/2023

<https://www.resbymirvac.com>

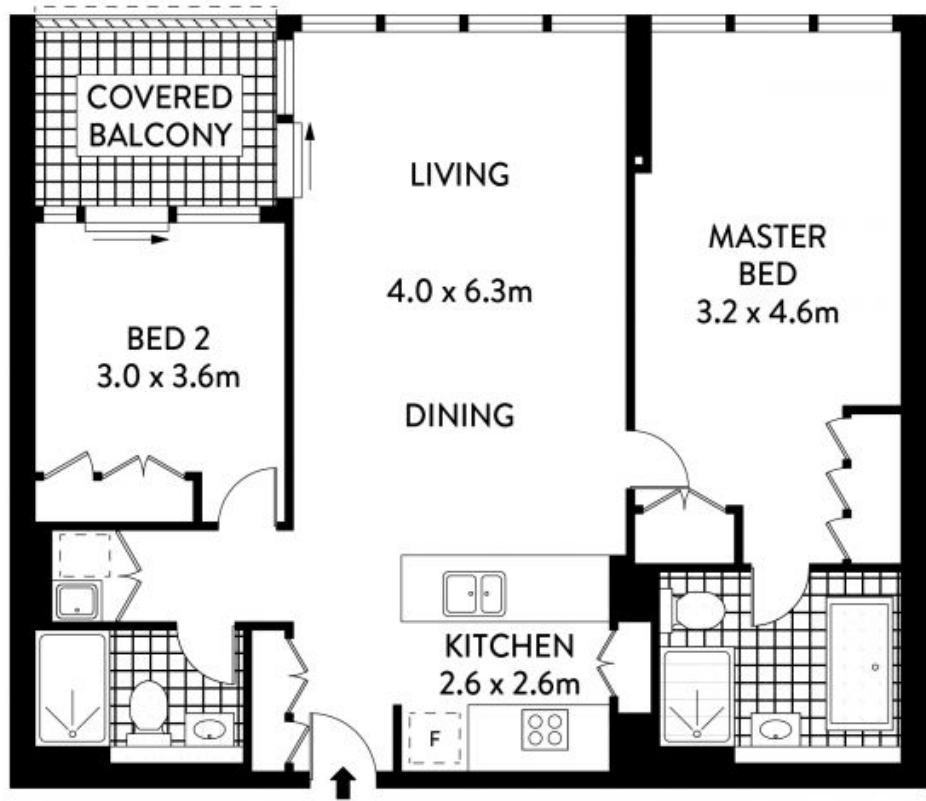
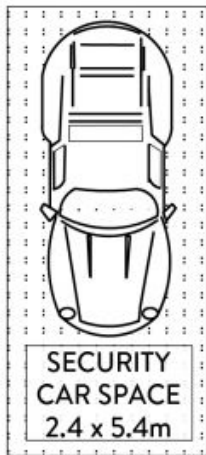

LEVEL SEVEN



PLANS SHOWN ONLY INDICATIVE OF LAYOUT. DIMENSIONS ARE APPROXIMATE.  
Floor plans by www.remaustralia.com  
Ref. No: 15229

INTERNAL	:	83m <sup>2</sup>
BALCONY	:	6m <sup>2</sup>
STORAGE CAGE	:	3m <sup>2</sup>
CAR SPACE	:	13m <sup>2</sup>



Plans shown are only indicative of layout. Dimensions are approximate.

705/486 PACIFIC HIGHWAY

ST LEONARDS

**St Leonards, NSW**  
705/486 Pacific Highway