



**DOCKLANDS, VIC**  
1205/81 South Wharf Drive

**2** BED **2** BATH **1** CAR



**North-Facing Forge Oasis is a Stylish Standout**  
With an enviable northerly aspect that allows for truly special views of the memorable city skyline, this two-bedroom with two-bathroom apartment in the Forge complex is one of the best opportunities in the Yarra's Edge precinct. With contemporary grace and a considered floorplan which makes the most of the space and views, this 10th floor apartment will have widespread appeal.

**\$710,000-\$730,000**  
**Contact:** Andrew Chen  
**Type:** Apartment  
**Sold Date:** 22/08/2022  
<https://www.resbymirvac.com>

- ? Sizeable open lounge and dining, stone kitchen, elegant cabinetry, SMEG appliances
- ? Three access points to balcony with panoramic CBD and Yarra River views
- ? Two bedrooms with built-in robes, master with ensuite, floor-to-ceiling windows

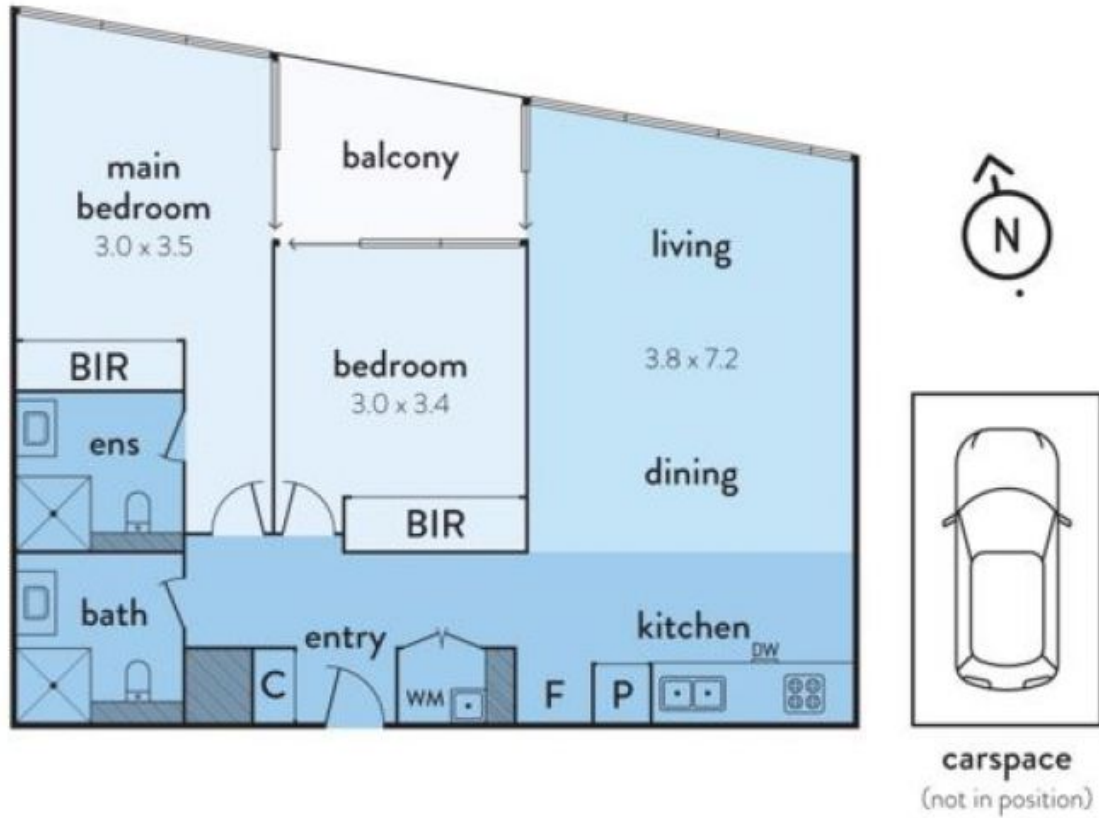

The above plan is an artist's impression only, it includes elements that are for display purposes and may not be to scale. Dimensions are approximate and every care has been taken to verify the accuracy of details.

Plans shown are only indicative of layout. Dimensions are approximate.

**DOCKLANDS, VIC**  
1205/81 South Wharf Drive