



DOCKLANDS, VIC
2207/50 Lorimer Street

1 BED **1** BATH **1** CAR



Spacious Yarra's Edge Oasis
Unfurnished- Situated in 'Tower 1' of Mirvac's multi award winning riverfront precinct, Yarra's Edge. A stylish and enviable space featuring;

- Full length balcony
- Open living/ dining zone
- Large bedroom with BIR
- Floor to ceiling windows allow an abundance of light
- Ample kitchen storage

LEASED
Contact: Aleisha Clark
03 9645 1199
0491 174 507
Andrew Chen
0400 616 861
Type: Apartment
Date Available: 10/05/2022
Leased Date: 11/05/2022
Bond: \$2085
<https://www.resbymirvac.com>

2207/50 LORIMER STREET, DOCKLANDS



This floorplan is an artist's impression only, it contains information that we believe to be reliable however we cannot guarantee and accept no responsibility for the accuracy of information supplied. All dimensions are indicative and listed in metres. Interested parties should take their own measurements or engage the services of a licensed surveyor.

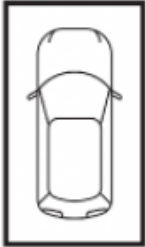
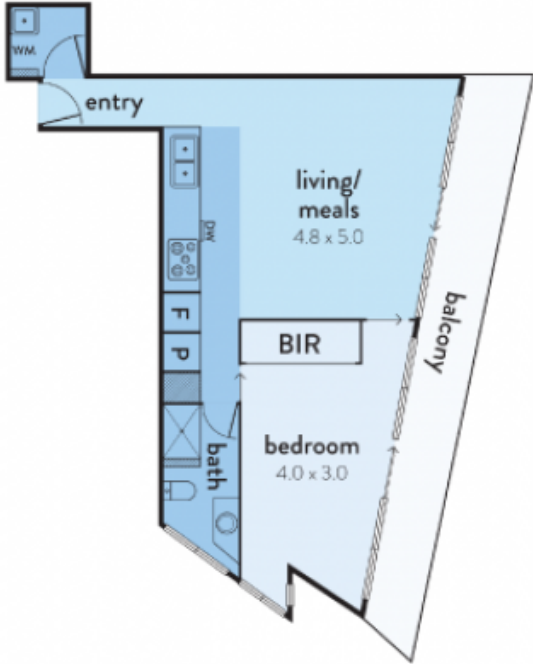

carspace
(not in position)

Plans shown are only indicative of layout. Dimensions are approximate.