



INDICATIVE ONLY



## DOCKLANDS, VIC

1502/100 Lorimer Street

1  
BED

1  
BATH

1  
CAR



real estate  
services  
by mirvac

### An Array of stunning Docklands highlights awaits

Experience one of the largest and most luxurious 1Bedroom plus study apartments on offer in the renowned Yarra's Edge tower. Featuring an abundance of brilliant space, a northern aspect with picturesque marina views and a location within the prominent Yarra's Edge district. This is a lifestyle second to none.

Apartment features;

Expansive open plan living/dining area  
Kitchen splashed with stone bench tops  
Stainless steel Miele kitchen appliances

### River views for \$460pw

Contact: Aleiasha Clark  
0491 174 507

Type: Apartment

Date Available: 30/11/2021

Leased Date: 03/12/2021

Bond: \$1998

<https://www.resbymirvac.com>

# 1502/100 LORIMER STREET, DOCKLANDS

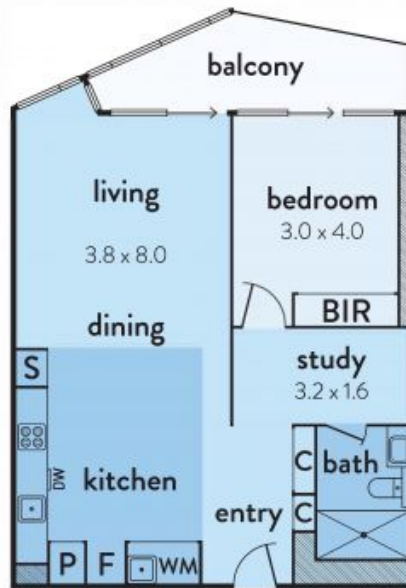

This floorplan is an artist's impression only, it contains information that we believe to be reliable however we cannot guarantee and accept no responsibility for the accuracy of information supplied. All dimensions are indicative and listed in metres. Interested parties should take their own measurements or engage the services of a licensed surveyor.

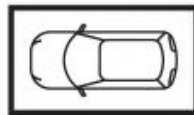

**carspace**  
(not in position)



Plans shown are only indicative of layout. Dimensions are approximate.

**DOCKLANDS, VIC**  
1502/100 Lorimer Street