

Glebe, NSW

415/2 Scotsman Street

1
BED

1
BATH



Peaceful, North Facing 1-Bedroom Apartment in Harold Park, Glebe

This 55sqm, 4th floor apartment features:

- Well appointed bedroom with built-in wardrobes
- Open-plan living and dining area, flowing onto North facing balcony
- Sleek kitchen with stone benchtop and built-in Miele appliances
- Modern bathroom with plenty of storage
- Internal laundry with washing machine and dryer included
- Secure storage cage included
- Ducted A/C, video intercom and NBN connectivity
- 450m to the Heritage-listed Tramsheds, light rail and public transport

More apartments available!

Contact: Carmen Whiteley
02 8588 8888
0497 555 519

Type: Apartment

Date Available: 12/11/2021

<https://www.resbymirvac.com>

For more information please contact Real Estate Services by Mirvac on 02 8588 8888 or email enquiries@resbymirvac.com - Your Onsite Agent!

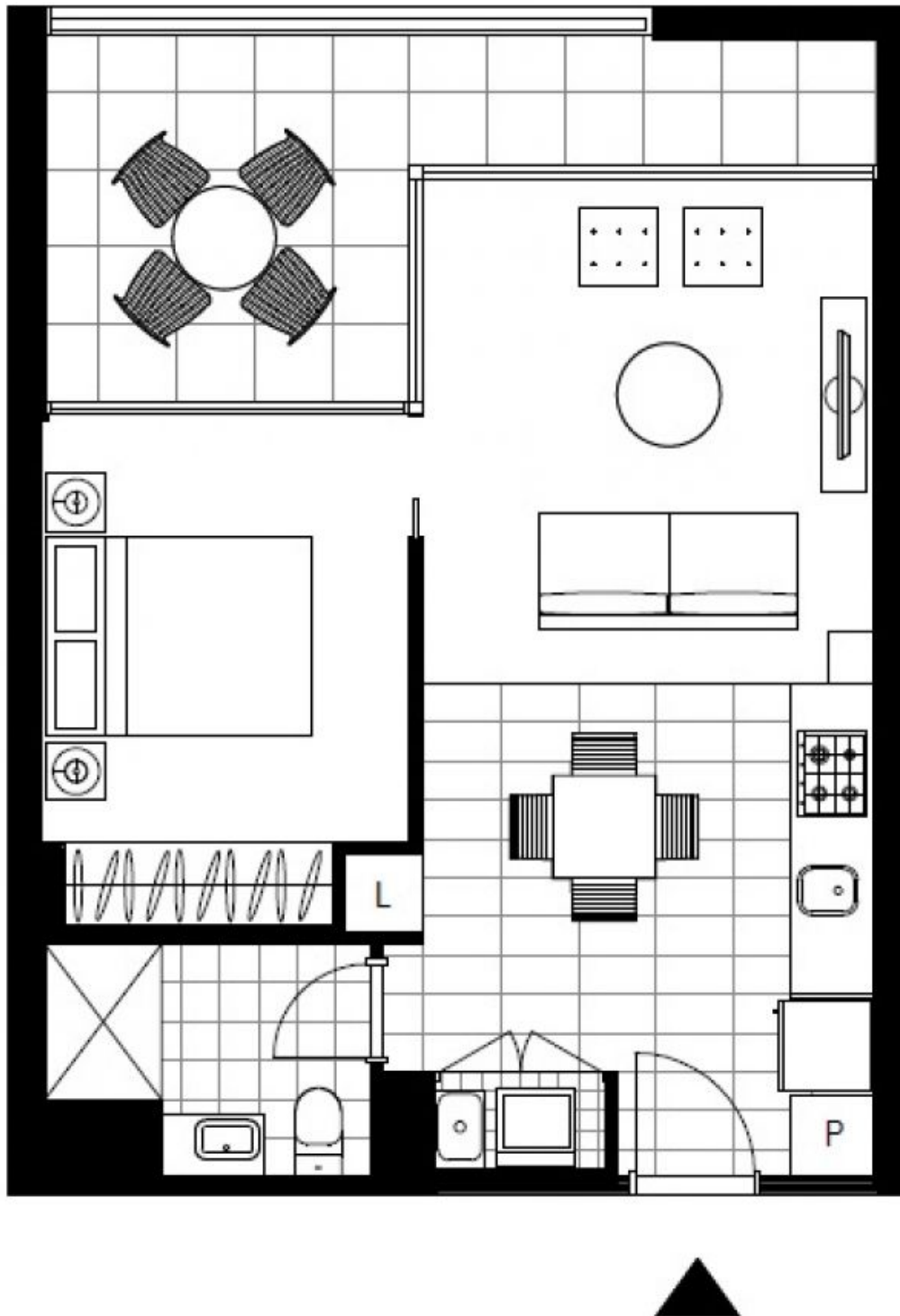

Plans shown are only indicative of layout. Dimensions are approximate.

Glebe, NSW
415/2 Scotsman Street