



DONCASTER, VIC
58 Members Drive

3 BED **2** BATH **1** CAR



****UNDER OFFER ****

3Bedroom townhouse in Mirvac's master planned Tullamore estate

Private inspections available NOW!! Contact Aleiasha Clark 0491 174 507 or Abigail Fitzpatrick 0491 091 818

Tullamore is set to elevate the lifestyle of its residents, with lush parkland on its doorstep; where style, privacy and timeless design blends with nature, beauty and freedom. Unique, exclusive and limited, this is a lifestyle of distinction.

- Bespoke design, quality construction and finishes
- 1 Car Garage with internal access
- Stainless steel Miele appliances including integrated dishwasher

UNDEROFFER

Contact: Aleiasha Clark
03 9645 1199
0491 174 507

Type: Townhouse

Date Available: 22/10/2021

Leased Date: 15/11/2021

Bond: \$2672

<https://www.resbymirvac.com>

COPPIN, SINGLE GARAGE
 Lot M417-M420, M423-M425
 Members Drive

3 BEDROOM

GROUND FLOOR	69.1
FIRST FLOOR	66.1
	135.2
PORCH	0.0
GARAGE	23.8
	25.8
TOTAL AREA	162.0



Note: Please note that this document is a guide only and was prepared prior to completion. The information contained herein is believed to be correct but is not guaranteed. Centers are indicative and purchasers should view fixtures on colour sample board. Dimensions are approximate and floor are completed in accordance with the Property Council of Australia.

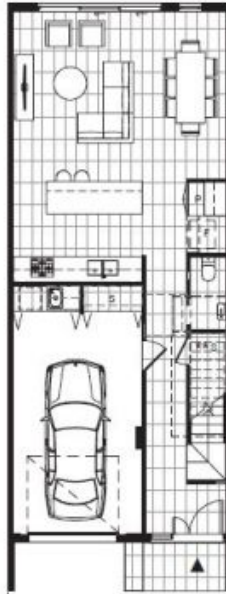

GROUND FLOOR



FRIST FLOOR

Plans shown are only indicative of layout. Dimensions are approximate.

DONCASTER, VIC
 58 Members Drive