



AINTREE, VIC
75 Wireless Drive

4 BED **3** BATH **2** CAR



NEWLY ESTABLISHED 4 bedroom Woodlea townhouse

*Inspection Code: 9645

\$430 per week

Contact: Aleiasha Clark
03 9645 1199
0491 174 507

Quality is paramount in this superb four bedroom townhouse boasting prime location within the Woodlea Estate.

Type: Townhouse

Date Available: 15/10/2021

Leased Date: 22/11/2021

Melding the best of contemporary design and open spaces, this quality family home comprises,

Bond: \$1868

<https://www.resbymirvac.com>

1st floor guest suite comprising of bedroom and ensuite

Master suite including WIR, sleek ensuite and balcony

Kitchen with island bench and walk-in pantry

900mm cooktop and oven and integrated dishwasher

Landscaped courtyard ? perfect for entertaining

Area Schedule

| | |
|--------------|---------------------|
| Land | 181.5m ² |
| Total Living | 170.7m ² |
| Garage | 41.6m ² |
| Balcony | 4.2m ² |



Ground Floor

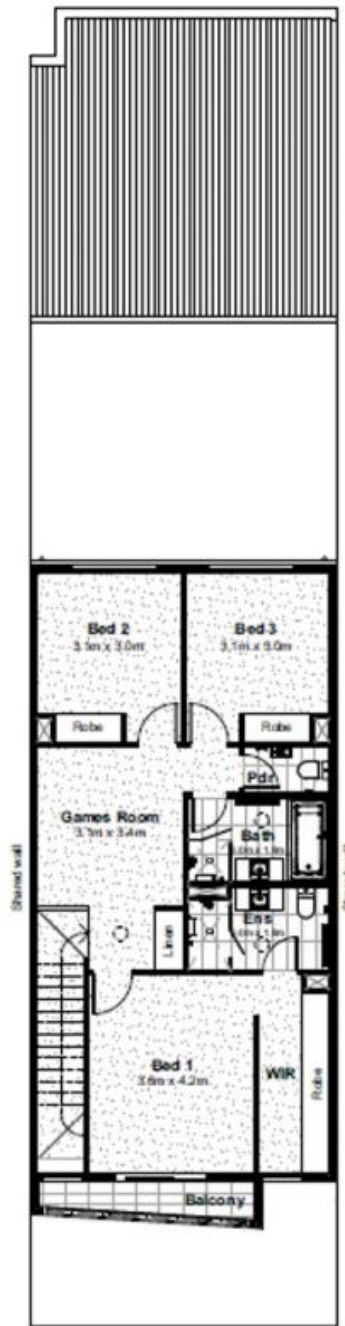

First Floor

Plans shown are only indicative of layout. Dimensions are approximate.