



**AINTREE, VIC**  
73 Wireless Drive

**4** BED **3** BATH **2** CAR



**Newly established Woodlea townhouse**

\*Inspection Code: 9645

Experience new era living with this stunning four bedroom family home built to the highest standard in the expansive master planned community, Woodlea. Perfect for those looking for a place to call home in a burgeoning community, residents can enjoy their own space whilst being part of a dynamic community with parks, retail, education, employment, commercial and community services all bourgeoning.

**\$430 per week**

**Contact:** Aleiasha Clark  
03 9645 1199  
0491 174 507

**Type:** Townhouse

**Date Available:** 30/09/2021

**Leased Date:** 19/10/2021

**Bond:** \$1868

<https://www.resbymirvac.com>

Melding the best of contemporary design and open spaces, this quality Mirvac built home comprises,

# Lot 37104 - Type 20

## Area Schedule

Land	181.5m <sup>2</sup>
Total Living	170.70m <sup>2</sup>
Garage	41.6m <sup>2</sup>
Balcony	4.2m <sup>2</sup>

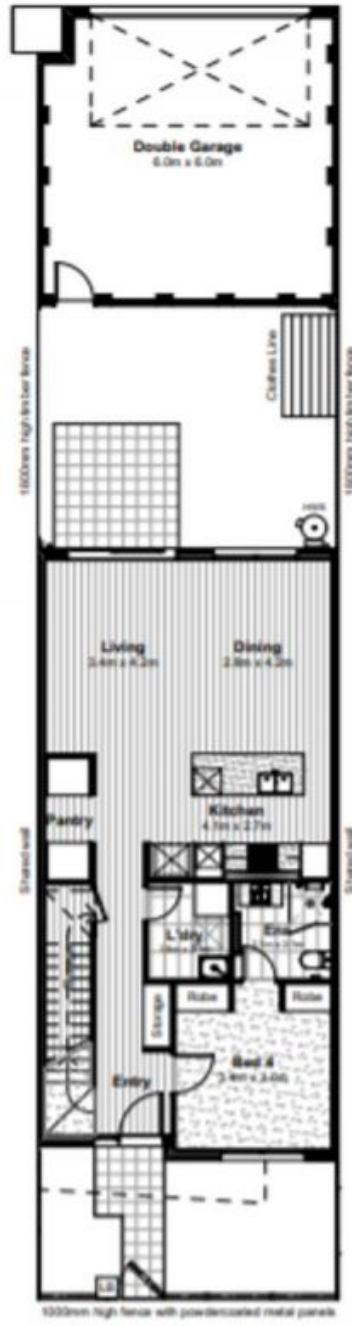

**Ground Floor**  
1:100

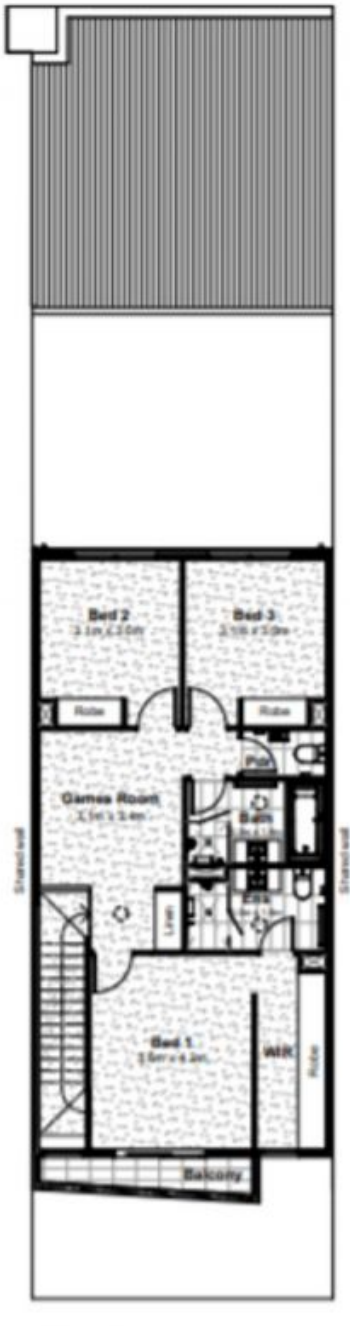

**First Floor**  
1:100

Plans shown are only indicative of layout. Dimensions are approximate.