



AINTREE, VIC
73 Wireless Drive

4 BED **3** BATH **2** CAR



Newly established Woodlea townhouse
*Inspection Code: 9645

Experience new era living with this stunning four bedroom family home built to the highest standard in the expansive master planned community, Woodlea. Perfect for those looking for a place to call home in a burgeoning community, residents can enjoy their own space whilst being part of a dynamic community with parks, retail, education, employment, commercial and community services all burgeoning.

\$430 per week
Contact: Aleiasha Clark
 0491 174 507
 Andrew
 Chen
 0491 106 861
Type: Townhouse
Date Available: 30/09/2021
Leased Date: 19/10/2021
Bond: \$1868
<https://www.resbymirvac.com>

Melding the best of contemporary design and open spaces, this quality Mirvac built home comprises,

Lot 37104 - Type 20

Area Schedule

Land	181.5m ²
Total Living	170.70m ²
Garage	41.6m ²
Balcony	4.2m ²

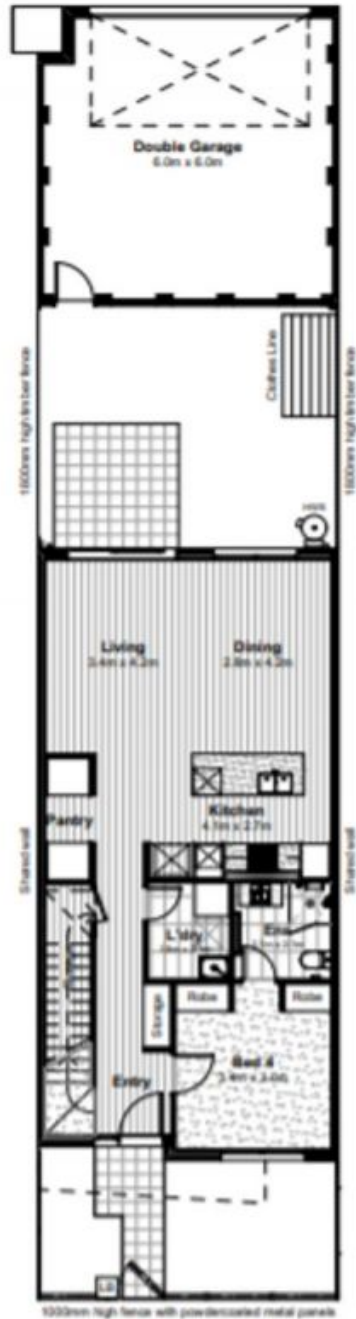

Ground Floor

1:100

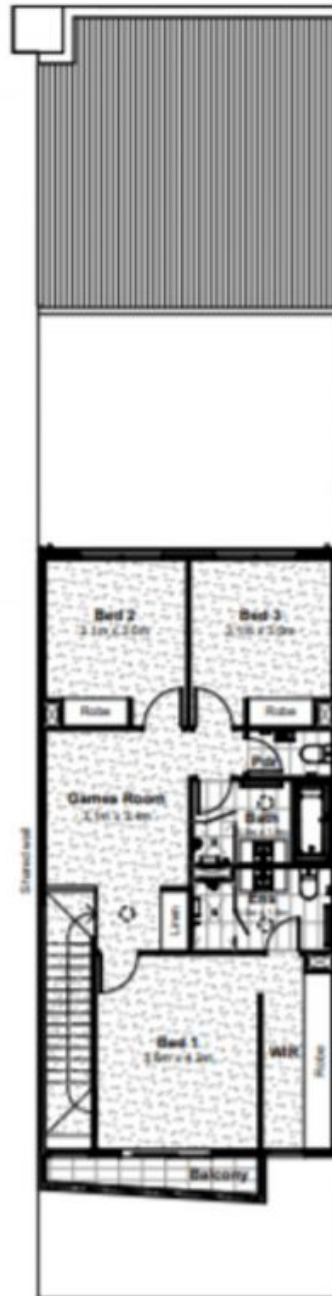

First Floor

1:100

Plans shown are only indicative of layout. Dimensions are approximate.

AINTREE, VIC
73 Wireless Drive