



DOCKLANDS, VIC

1005/81 South Wharf Drive

2
BED

2
BATH

1
CAR



North-Facing Forge Oasis is a Stylish Standout

With an enviable northerly aspect that allows for truly special views of the memorable city skyline, this two bedroom, two bathroom apartment in the Forge complex is one of the best opportunities in the Yarra's Edge precinct.

With contemporary grace and a considered floorplan which makes the most of the space and views, this 10th floor apartment will have widespread appeal. Sizeable and open lounge and dining includes a dazzling stone kitchen featuring elegant cabinetry and stainless steel SMEG appliances.

There are three access points out to the balcony (from central living and both bedrooms), with this wonderful alfresco zone brilliant to soak in the CBD and Yarra River views as well as out to the rest of the Docklands. Both bedrooms are equipped with built-in robes including the master haven which also delivers an ensuite. You can enjoy full length windows taking in the breathtaking City and Yarra panoramas & natural

sunlight. Also enjoy a sumptuous bathroom, concealed laundry, ducted heating and cooling, video intercom, and a secure car space.

Forge apartments is all about luxury living, resort style facilities and convenience. Residents also has access to the Wharf's Club with gym, pool and caf? as well as a private kitchen/dining room and cinema.

All of this just a short walk to some of the best waterfront cafes, South Wharf retail shopping and Crown Promenade dining.

\$710,000

Contact: Andrew
Chen

Type: Apartment 1061

Sold Date: 11/03/2022

<https://www.resbymirvac.com>

1005/81 SOUTH WHARF DRIVE, DOCKLANDS

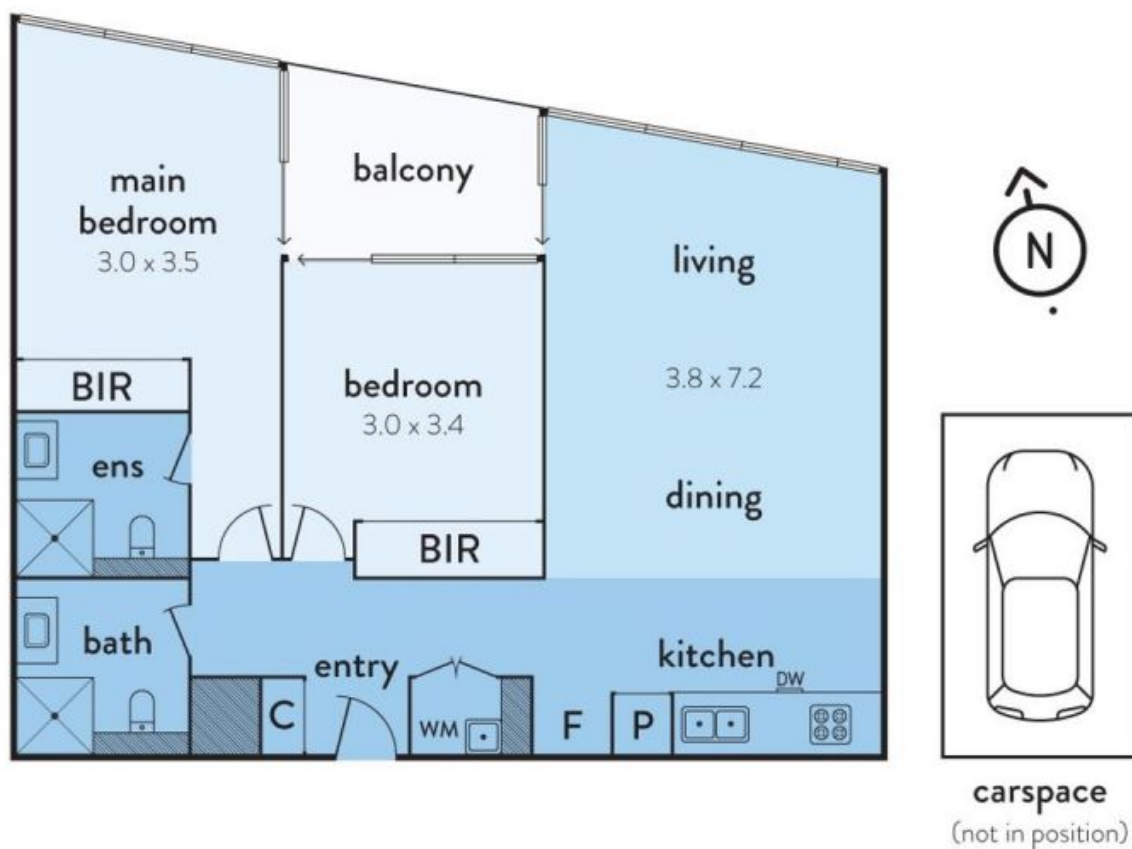

real estate
services
by mirvac

Plans shown are only indicative of layout. Dimensions are approximate.

The above plan is an artist's impression only, it includes elements that are for display purposes and may not be to scale. Dimensions are approximate and every care has been taken to verify the accuracy of details.

DOCKLANDS, VIC
1005/81 South Wharf Drive