



DOCKLANDS, VIC

806/81 South Wharf Drive

2
BED

2
BATH

1
CAR



Furnished Corner Apartment with 270 degree views!

Welcome to 'Forge' Tower located in the premier Yarra's Edge precinct by Mirvac

Forge residents will enjoy spaces that extend their personal living environment. A private dining room and cinema can be reserved by residents who want to elevate their gathering. Set amongst plush surrounds and cityscape views in addition to the luxurious state-of-the-art health and wellbeing facility 'Wharf Club'; housed beneath an inclined grass roof comprising of pool, sauna and gymnasium.

\$680 per week

Contact: Aleiasha Clark
03 9645 1199
0491 174 507

Type: Apartment

Date Available: 21/03/2022

Leased Date: 20/08/2021

Bond: \$2954

<https://www.resbymirvac.com>

This breathtaking 2 Bedroom, 2 Bathroom, 1 Car space apartment features;



LOCATION
PLAN

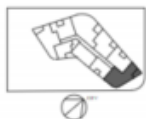

806/81 South Wharf Drive, Docklands

2 Bed | 2 Bath | 1 Car

Level 8

FURNISHED

- Panoramic views of the marina and Port Phillip Bay
- Internal area; 102M2
- Balcony area; 8M2
- Secure parking X1
- Winter garden

For more information, please contact:

Aleiasha Clark
0491 174 507
aleiasha.clark@resbymirvac.com



Plans shown are only indicative of layout. Dimensions are approximate.

DOCKLANDS, VIC
806/81 South Wharf Drive