

## EAST MELBOURNE, VIC

507/280 Albert Street

**1**  
BED

**1**  
BATH



### Parkside brilliance with the city steps away!

Here is your chance to own a piece of one of Melbourne's most luxurious and sought-after residential complexes. This sensational 1 bedroom apartment in the incredible 'The Eastbourne complex' delivers interiors that are first class, matched only by generous internal space and a wonderful northern orientation.

**\$680,000 - \$720,000**

**Contact:** Baden Lucas  
03 9645 1199  
0418 888 751

**Type:** Apartment

**Sold Date:** 05/07/2021

<https://www.resbymirvac.com>

? The acclaimed 'The Eastbourne' complex comes from quality developer Mirvac and renowned Bates Smart architects

? Welcoming port cochere at the front leads into a grand entry lobby that has you feeling like you're stepping into a 5-star hotel

? Complex overlooks the picturesque Fitzroy Gardens

? Apartment enjoys 71 sqm (approx.) of total space which is large for 1 bedroom properties

# 507/280 ALBERT STREET, EAST MELBOURNE



This floorplan is an artist's impression only, it contains information that we believe to be reliable however we cannot guarantee and accept no responsibility for the accuracy of information supplied. All dimensions are indicative and listed in metres. Interested parties should take their own measurements or engage the services of a licensed surveyor.



**real estate  
services**  
by mirvac

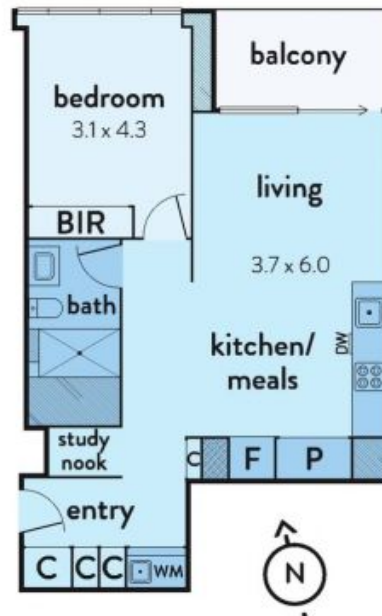

**storage  
cage**  
(not in position)

Plans shown are only indicative of layout. Dimensions are approximate.

**EAST MELBOURNE, VIC**  
507/280 Albert Street