



DOCKLANDS, VIC

2401/80 Lorimer Street

3
BED

2
BATH

3
CAR



Bay and city views from this astounding 24th floor sensation!

Stunningly placed on the 24th floor of Yarra's Edge 'Tower 4', this exceptional 3 bedroom, 2 bathroom, 3 car space sub-penthouse is the pinnacle of spacious and stylish Docklands living. With phenomenal views of the gorgeous Port Phillip Bay and the city skyline, you'll appreciate the contemporary charm and high end quality of this treasured modern residence.

? This property offers marvellous indoor/outdoor space over 210 sqm (approx.) to enjoy

? Generous entry makes a wonderful first impression

? Expansive and light-filled central living gives you plenty of lounge and dining options as well as remarkable views of the bay, city, Yarra River, and northern ranges

Contact Agent

Contact: Baden Lucas
03 9645 1199
0418 888 751

Type: Apartment

Sold Date: 28/07/2021

<https://www.resbymirvac.com>

2401/80 LORIMER STREET DOCKLANDS



This floorplan is an artist's impression only, it contains information that we believe to be reliable however we cannot guarantee and accept no responsibility for the accuracy of information supplied. All dimensions are indicative and listed in metres. Interested parties should take their own measurements or engage the services of a licensed surveyor.

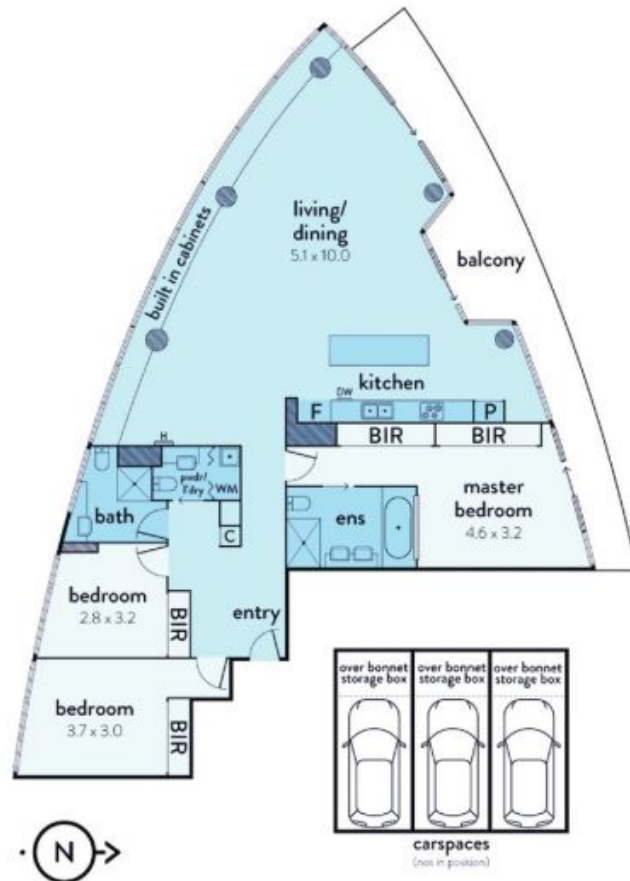

Plans shown are only indicative of layout. Dimensions are approximate.

DOCKLANDS, VIC
2401/80 Lorimer Street