



DOCKLANDS, VIC
411/81 South Wharf Drive

1 BED **1** BATH **1** CAR



Great Sized Dual Level One Bedroom Apartment with Great Views!

Unfurnished & never been rented before - Grab a slice of the utterly luxurious, relaxed, and comfortable Docklands life with this brand new dual level one bedroom apartment with a northern orientation, which has an enviable location in Yarra's Edge newest residential jewel, 'Forge Apartments'.

An incredibly unique floorplan is split into two distinct levels allowing for dedicated and private areas to live and sleep. The generous living zone has an abundance of space for both lounge and dining while also integrating the stylish stone kitchen which is pleasing on the eye with elegant cabinetry and stainless steel appliances.

\$450 per week
Contact: Baden Lucas
 03 9645 1199
 0418 888 751
Type: Apartment
Date Available: 23/03/2021
Leased Date: 09/04/2021
Bond: \$1955
<https://www.resbymirvac.com>

411/81 SOUTH WHARF DRIVE, DOCKLANDS

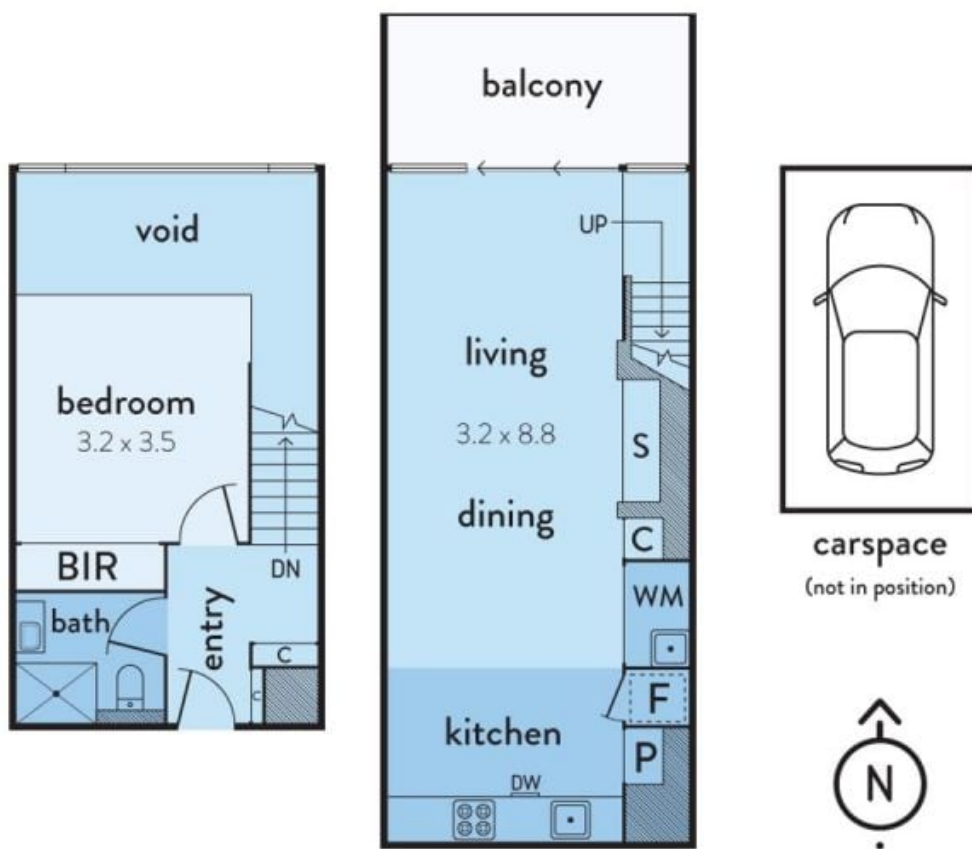

Plans shown are only indicative of layout. Dimensions are approximate.

The above plan is an artist's impression only, it includes elements that are for display purposes and may not be to scale. Dimensions are approximate and every care has been taken to verify the accuracy of details.

DOCKLANDS, VIC
411/81 South Wharf Drive