



DOCKLANDS, VIC
1406/1 Point Park Crescent

2 BED **1** BATH **1** CAR



Live in style in this exceptional Yarra Point abode
This excellent 14th floor residence is an ideal choice for first home owner-occupiers and investors alike. The light-filled and relaxed central living and meals provides a sizeable area suited for morning breakfasts and lazing in front of the TV after a long day at work. This zone further opens out to a long balcony where you can enjoy summer sunsets with wine or beer in hand.

\$555,000 - \$595,000
Contact: Baden Lucas
03 9645 1199
0418 888 751
Type: Apartment
Sold Date: 05/07/2021
<https://www.resbymirvac.com>

The stone kitchen has a high end feel with luxe benchtops, integrated refrigerator, built-in microwave and stainless steel Miele appliances. Both bedrooms are equipped with built-in robes and are in close proximity to the gorgeous bathroom, meanwhile further embrace a European laundry, ducted heating and cooling, secure intercom, secure car space. Free access to RekDek with a gymnasium, 25m indoor heated lap pool, spa, steam room, and sauna. Building amenities include a library, business center, outdoor herbs garden with BBQ machine, on-site gym, and free under covered visitors car parking.

1406/1 POINT PARK CRESCENT, DOCKLANDS



This floorplan is an artist's impression only, it contains information that we believe to be reliable however we cannot guarantee and accept no responsibility for the accuracy of information supplied. All dimensions are indicative and listed in metres. Interested parties should take their own measurements or engage the services of a licensed surveyor.

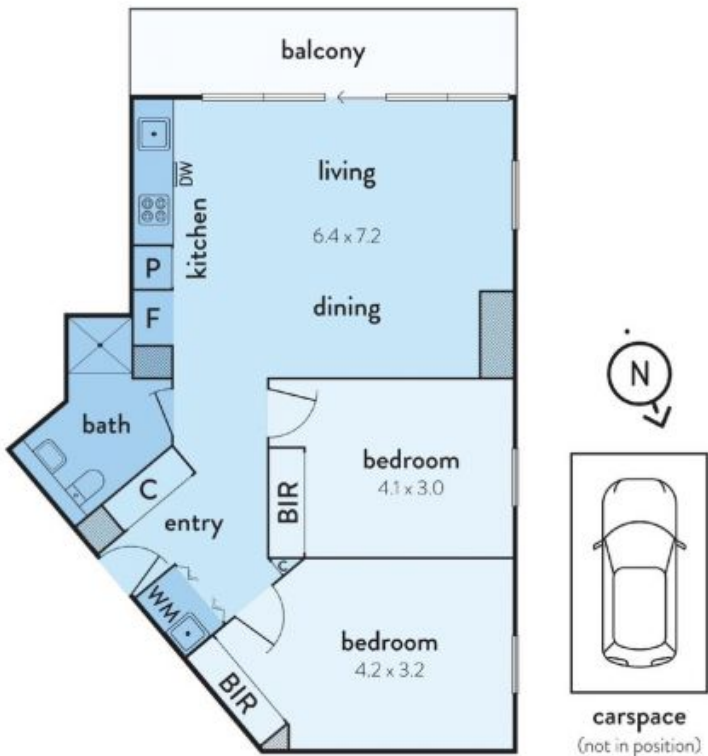

Plans shown are only indicative of layout. Dimensions are approximate.

DOCKLANDS, VIC
1406/1 Point Park Crescent