



DOCKLANDS, VIC

3004/1 Point Park Crescent

3
BED

2
BATH

2
CAR



Breathtaking Sub-penthouse living with exceptional city and bay views

Superbly positioned on the 30th floor with breathtaking 270 degree views of the City Skyline, Yarra River, Bolte Bridge, through to Port Phillip Bay, is this luxurious and spacious sub penthouse apartment. You will be impressed by the open plan living and dining room with high ceilings and floor to ceiling windows to relax and enjoy the stunning views from every aspect of Melbourne. The stylish modern stone kitchen offers Miele appliances including steamer, coffee machine, integrated fridge and meals bench area and opening onto wind a protected terrace, perfect for entertaining. The 3 double bedrooms have floor to ceiling windows most would envy and with built-in robes (main bedroom with full luxurious bathroom ensuite with spa bath), separate study area, central sparkling bathroom, separate laundry, ducted central heating and cooling, audio system, 2 secure car parks and storage.

\$1,400,000 - \$1,450,000

Contact:

Baden Lucas

03 9645 1199

0418 888 751

Baden Lucas

03 9645 1199

0418 888 751

Type:

Apartment

Sold Date:

30/04/2021

<https://www.resbymirvac.com>

3004/1 POINT PARK CRESCENT, DOCKLANDS



This floorplan is an artist's impression only, it contains information that we believe to be reliable however we cannot guarantee and accept no responsibility for the accuracy of information supplied. All dimensions are indicative and listed in metres. Interested parties should take their own measurements or engage the services of a licensed surveyor.

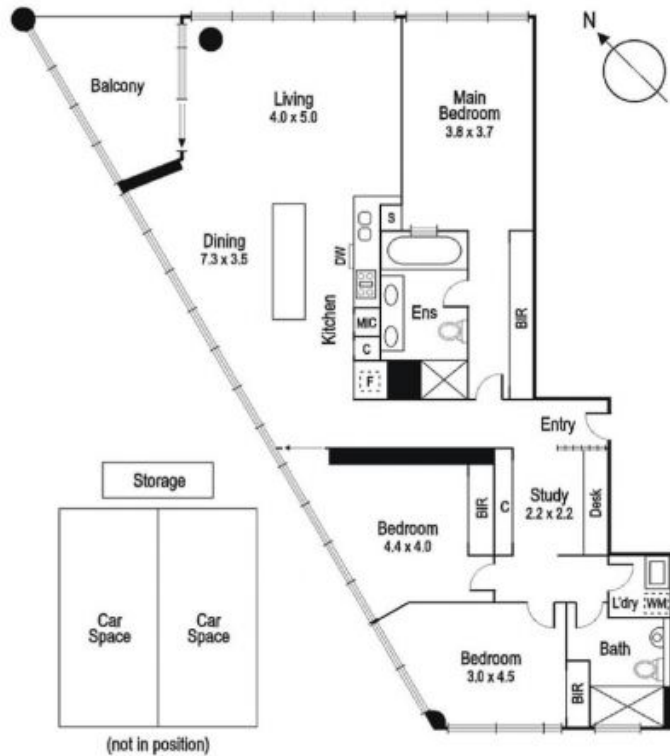

Plans shown are only indicative of layout. Dimensions are approximate.

DOCKLANDS, VIC
3004/1 Point Park Crescent