



## EAST MELBOURNE, VIC

720/280 Albert Street

2  
BED

2  
BATH

1  
CAR



### Undoubted luxury, superb space, and memorable gardens views

The 'Eastbourne' residential complex is quite simply one of the most exclusive and sought-after buildings in all of Melbourne. So don't miss this rare chance to enjoy luxurious, ultra-spacious, and sophisticated East Melbourne living with this exceptional 2 bedroom + study, 2 bathroom, 1 car apartment situated directly opposite the picturesque Fitzroy Gardens, and Melbourne CBD.

- ? Enjoy wonderful views of Fitzroy Gardens and the CBD
- ? Bespoke 7th floor apartment offers first class fittings and fixtures and generous proportions
- ? Enjoy sensational views and grand space in the open living and meals zone

### Contact Agent

**Contact:** Baden Lucas  
03 9645 1199  
0418 888 751

**Type:** Apartment

**Sold Date:** 17/02/2021

<https://www.resbymirvac.com>

# 720/280 ALBERT STREET EAST MELBOURNE



This floorplan is an artist's impression only, it contains information that we believe to be reliable however we cannot guarantee and accept no responsibility for the accuracy of information supplied. All dimensions are indicative and listed in metres. Interested parties should take their own measurements or engage the services of a licensed surveyor.

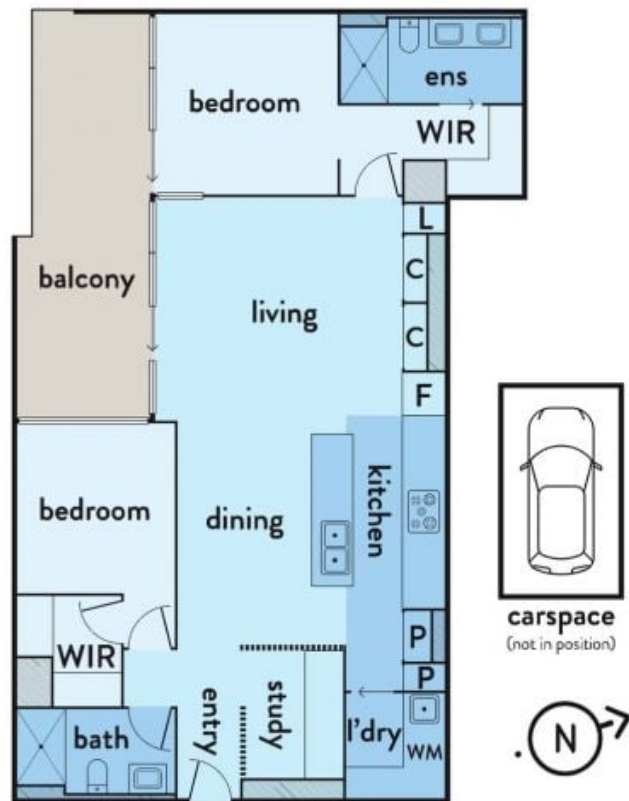

Plans shown are only indicative of layout. Dimensions are approximate.

**EAST MELBOURNE, VIC**  
720/280 Albert Street