



DOCKLANDS, VIC

507/94 River Esplanade

2
BED

2
BATH

2
CAR



real estate
services
by mirvac

The apex of luxurious and generous ?Tower 5' living

A masterpiece of stunningly renovated apartment living which further delivers a wealth of incredible indoor and outdoor space and an enviable riverside location allowing for breathtaking views of the marina and CBD, this 2 bedroom, 2 bathroom, 2 car space apartment is simply spectacular!

On the top floor of the boutique section of the ?Tower 5' complex in Yarra's Edge, this stellar apartment has a genuine penthouse feel to it while also promising 128 sqm of total space.

? Make the most of the north-east orientation as well as terrific privacy with only two direct neighbours

? Refurbished updates include grand oak timber flooring, high quality carpet, and motorised blinds in the living zone and bedrooms

Contact Agent

Contact: Mia Chen
03 9645 1199
0428 096 132
Mark Sutherland
03 9645 1199
0418 691 585

Type: Apartment

Sold Date: 23/06/2020

<https://www.resbymirvac.com>

507/94 RIVER ESPLANADE, DOCKLANDS

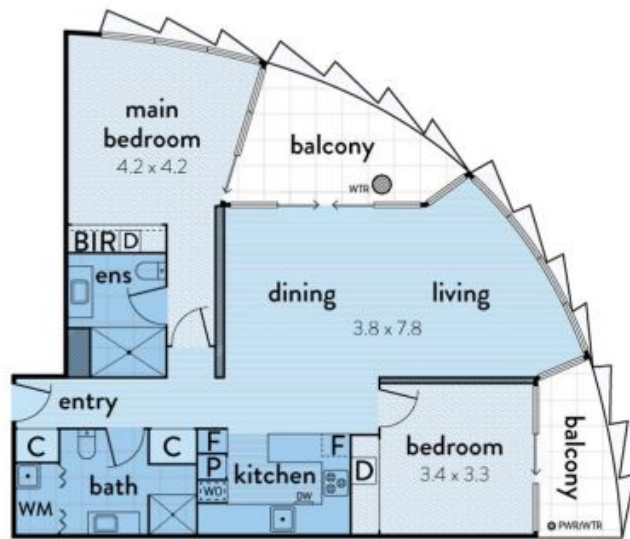

This floorplan is an artist's impression only, it contains information that we believe to be reliable however we cannot guarantee and accept no responsibility for the accuracy of information supplied. All dimensions are indicative and listed in metres. Interested parties should take their own measurements or engage the services of a licensed surveyor.

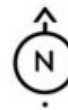
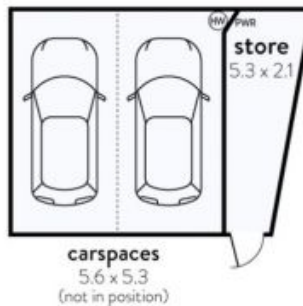

Plans shown are only indicative of layout. Dimensions are approximate.

DOCKLANDS, VIC
507/94 River Esplanade