



**FOR & BETTER
SECTION OPTIONS**

are here to make the move to
home simple, safe and flexible.

Inspections
ours
Meetings

STER NOW
EASY STEPS

ook Inspection"
your details
pection method

**APPLY NOW
VIA FORM FOR
PRE-APPROVAL
ON ALL
PROPERTIES**

**RES real estate
services
by mirvac**



DONCASTER, VIC

60 Members Drive

3 **2** **1**
BED BATH CAR

RES

Brand new 3 bedroom townhouse in sought after Tullamore Estate

Tullamore is set to elevate the lifestyle of its residents, with lush parkland on its doorstep; where style, privacy and timeless design blends with nature, beauty and freedom. Unique, exclusive and limited, this is a lifestyle of distinction.

Townhouse features:

- ? Bespoke design, quality construction and finishes
- ? 1 Car Garage with internal access
- ? Stainless steel Miele appliances including integrated dishwasher
- ? Large island bench and generous cupboard space
- ? Landscaped outdoor entertaining space
- ? Stylish tiled flooring

\$680 per week

Contact: Baden Lucas
03 9645 1199
0418 888 751

Type: Townhouse

Date Available: 05/05/2020

Leased Date: 19/05/2020

Bond: \$4080

<https://www.resbymirvac.com>

COPPIN, SINGLE GARAGE
Lot M417-M420, M423-M425
Members Drive

3 BEDROOM

GROUND FLOOR	69.1
FIRST FLOOR	66.1
	126.2
PORCH	3.0
GARAGE	23.8
	26.8
TOTAL AREA	162.0



Note: Please note that this document is a guide only and was prepared prior to completion. The information contained herein is believed to be correct but is not guaranteed. Colors are indicative and purchasers should view finishes on color sample board. Dimensions are approximate and error are calculated in accordance with the Property Council of Australia

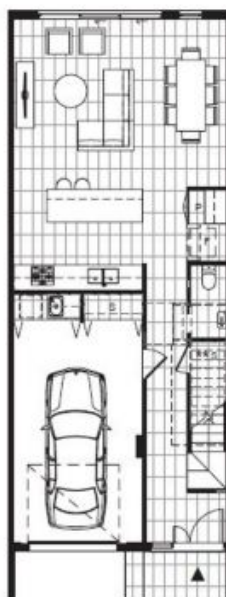

GROUND FLOOR



FIRST FLOOR

Plans shown are only indicative of layout. Dimensions are approximate.

DONCASTER, VIC
60 Members Drive