



**R & BETTER  
ECTION OPTIONS**

are here to make the move to  
home simple, safe and flexible.

Inspections  
ours  
Meetings

**STER NOW  
ASY STEPS**

ook Inspection"  
your details  
pection method

**APPLY NOW  
VIA FORM FOR  
PRE-APPROVAL  
ON ALL  
PROPERTIES**

**RES** real estate  
services  
by mirvac



**DONCASTER, VIC**  
48 Members Drive

**3** BED **2** BATH **1** CAR **RES**

**Brand new 3 bedroom townhouse in sought after Tullamore Estate**

Tullamore is set to elevate the lifestyle of its residents, with lush parkland on its doorstep; where style, privacy and timeless design blends with nature, beauty and freedom. Unique, exclusive and limited, this is a lifestyle of distinction.

**Townhouse features:**

- ? Bespoke design, quality construction and finishes
- ? 1 Car Garage with internal access
- ? Stainless steel Miele appliances including integrated dishwasher
- ? Large island bench and generous cupboard space
- ? Landscaped outdoor entertaining space
- ? Stylish tiled flooring

**\$625 per week**

**Contact:** Baden Lucas  
03 9645 1199  
0418 888 751

**Type:** Townhouse

**Date Available:** 04/05/2020

**Leased Date:** 22/06/2020

**Bond:** \$2716

<https://www.resbymirvac.com>

**COPPIN, SINGLE GARAGE**  
 Lot M417-M420, M423-M425  
 Members Drive

**3 BEDROOM**

GROUND FLOOR	69.1
FIRST FLOOR	66.1
	135.2
PORCH	3.0
GARAGE	23.8
	26.8
TOTAL AREA	162.0



Note: Please note that this document is a guide only and was prepared prior to completion. The information contained herein is believed to be correct but is not guaranteed. Colors are indicative and purchasers should view finishes on color sample board. Dimensions are approximate and areas are calculated in accordance with the Property Council of Australia.

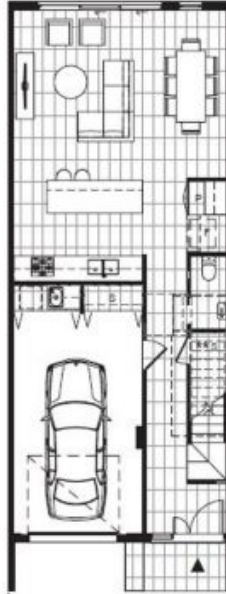

GROUND FLOOR



FIRST FLOOR

Plans shown are only indicative of layout. Dimensions are approximate.

**DONCASTER, VIC**  
 48 Members Drive