



## DOCKLANDS, VIC

3404/90 Lorimer Street

**2**  
BED

**1**  
BATH

**2**  
CAR



**\*Book now for your private inspection or video/Facetime tour\* Tower 5: Inspired Yarra's Edge living with gorgeous bay views**

*\*Book now for your private inspection or video/Facetime tour\**

Take advantage of stunning views of Port Phillip Bay, immaculate and spacious internal living, and a spot in the coveted 'Tower 5' complex in the Yarra's Edge precinct with this contemporary 2 bedroom 34th floor residence!

? Sizeable entertainer's balcony delivers incredible views of Port Phillip Bay

? Generous living and meals has balcony access and superb natural light

? Elegant kitchen is equipped with a moveable island bench and stainless steel Miele appliances

**\$700,000 - \$750,000**

**Contact:**

Baden Lucas

03 9645 1199

0418 888 751

**Type:**

Apartment

**Sold Date:**

20/04/2020

<https://www.resbymirvac.com>

# 3404/90 LORIMER STREET, DOCKLANDS



This floorplan is an artist's impression only, it contains information that we believe to be reliable however we cannot guarantee and accept no responsibility for the accuracy of information supplied. All dimensions are indicative and listed in metres. Interested parties should take their own measurements or engage the services of a licensed surveyor.

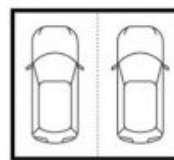
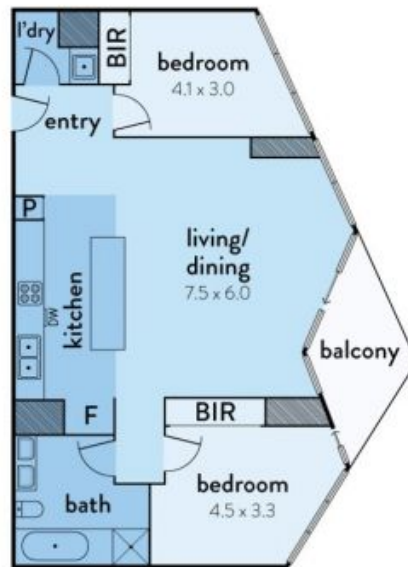

**carspaces**  
(not in position)



**storage cage**  
(not in position)

Plans shown are only indicative of layout. Dimensions are approximate.

**DOCKLANDS, VIC**  
3404/90 Lorimer Street