



RES real estate services by mirvac



RES real estate services by mirvac



EAST MELBOURNE, VIC
515/280 Albert Street

1 BED **1** BATH



The Eastbourne - 1 Bedroom Apartment with integrated fridge ? Unfurnished

Unfurnished apartment. Images and photos are for illustrative purposes only

Quality is paramount in this superb one bedroom apartment boasting a prestigious location in The Eastbourne - East Melbourne's finest apartment complex positioned opposite Fitzroy Gardens just a heartbeat from the City.

The stylish interior includes a generous living area with prestige Miele appliances and integrated fridge/freezer, generous balcony, a sparkling bathroom and concealed laundry; plus one storage locker

\$550 per week
Contact: Baden Lucas
 03 9645 1199
 0418 888 751
Type: Apartment
Date Available: 25/11/2019
Leased Date: 29/11/2019
Bond: \$3300
<https://www.resbymirvac.com>

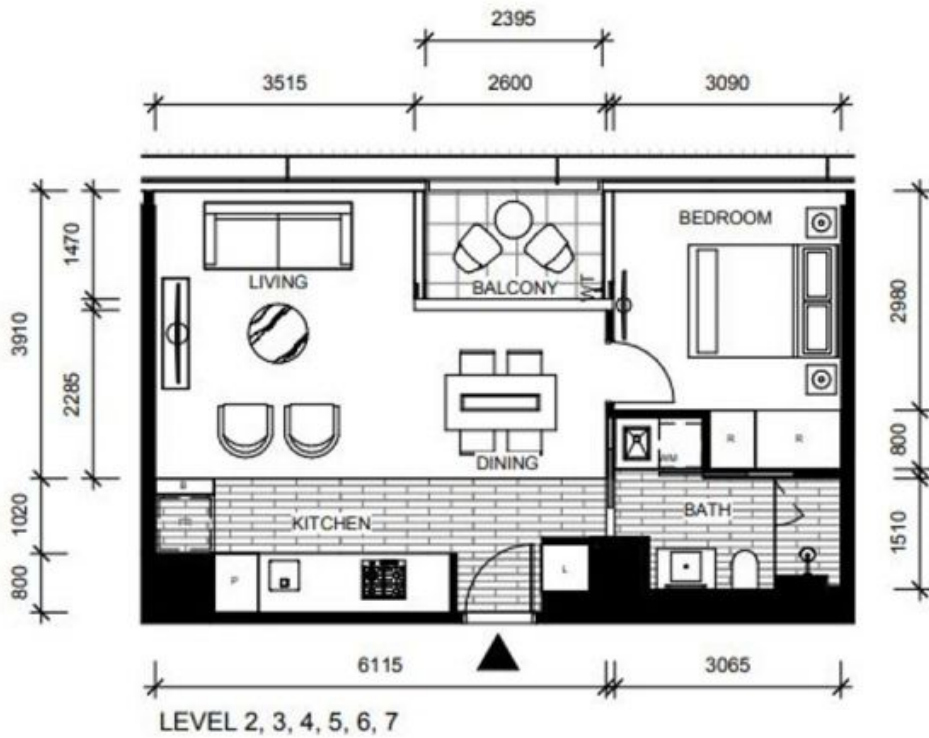

- APT 2-15
- APT 3-15
- APT 4-15
- APT 5-15
- APT 6-15
- APT 7-15

LOCATION PLAN

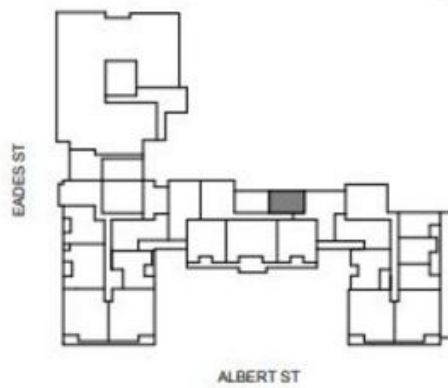

FOR CONSTRUCTION DIMENSIONED PLAN
APARTMENT
1 BED 1 BATH



- Non Trafficable Roof
 - Landscaping
 - Privacy Screen - Opague Glass Type 1
 - Privacy Screen - Opague Glass Type 2
 - Privacy Screen - Interstitial Louvre
- 0 1 2 3 4 5m

Plans shown are only indicative of layout. Dimensions are approximate.

EAST MELBOURNE, VIC
 515/280 Albert Street