



DOCKLANDS, VIC

2202/100 Lorimer Street

2
BED

2
BATH

2
CAR



Prime time 'Array' living with spectacular city views

Showcasing sweeping views of the CBD and marina, this immaculate and sophisticated 2 bedroom + study room, 2 bathroom, 2 car space apartment is an undoubted 'Array' superstar for any buyer who desires stylish and relaxed Yarra's Edge living.

? Sizeable balcony is the perfect vantage point to soak in the incredible city and water vistas

? Open plan living and dining has direct access out to the balcony

? Luxurious stone kitchen is immaculately presented and promises an island bench and stainless steel Miele appliances

? Master bedroom features a walk-in robe, striking double vanity ensuite with freestanding bath, and access out to the balcony

? 2nd bedroom with built-in robe storage

\$1,150,000 - \$1,200,000

Contact: Baden Lucas
03 9645 1199
0418 888 751

Type: Apartment

<https://www.resbymirvac.com>

2202/100 LORIMER STREET, DOCKLANDS

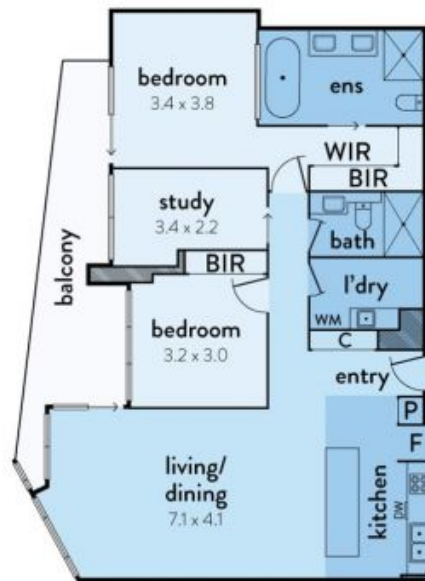

This floorplan is an artist's impression only, it contains information that we believe to be reliable however we cannot guarantee and accept no responsibility for the accuracy of information supplied. All dimensions are indicative and listed in metres. Interested parties should take their own measurements or engage the services of a licensed surveyor.

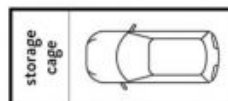

carspace
(not in position)

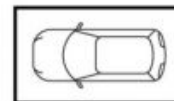

carspace
(not in position)



Plans shown are only indicative of layout. Dimensions are approximate.

DOCKLANDS, VIC
2202/100 Lorimer Street