



DOCKLANDS, VIC

307/64 River Esplanade

2
BED

1
BATH

1
CAR



The Best Of Docklands Living Within Your Reach

As its address suggests, this modern podium apartment is located on the third floor of the Yarra's Edge Tower 2 complex on the edge of the Yarra River. It's the perfect place to start or invest and become part of this exceptional waterfront playground near shops, restaurants, Victoria Harbour, Marvel Stadium, Southern Cross Station and Crown Entertainment Complex.

A fully appointed kitchen is open-plan to the living and dining room, which flows via sliding doors to a long entertaining terrace. Bringing soul-soothing serenity into the room, a wall of windows frames lush green outlooks. A second terrace capturing spectacular water and city outlooks flows off the first of the two bedrooms and both of the bedrooms are fitted with built-in robes. The designer bathroom incorporates a shower and toilet. Hallway storage and a European laundry round out the scenario.

\$770,000 - \$800,000

Contact: Baden Lucas
03 9645 1199
0418 888 751
Baden Lucas
03 9645 1199
0418 888 751

Type: Apartment

Sold Date: 02/12/2019

<https://www.resbymirvac.com>

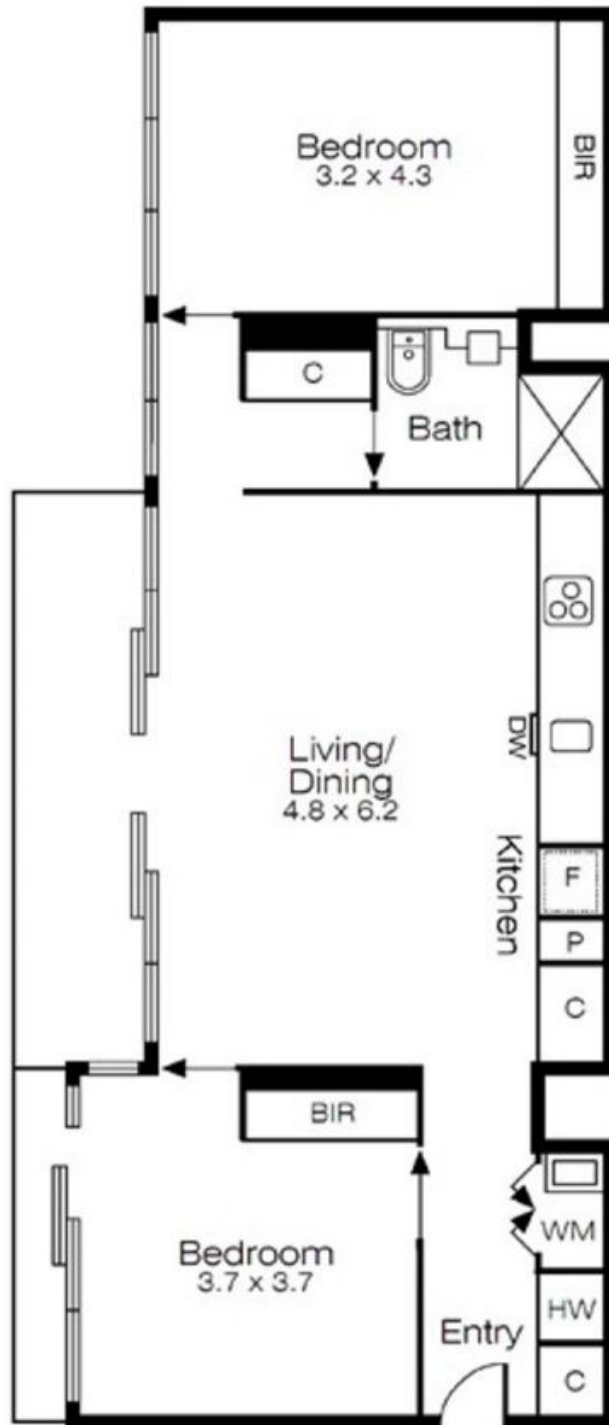

0m 2m

Plans shown are only indicative of layout. Dimensions are approximate.



Not to Scale

DOCKLANDS, VIC
307/64 River Esplanade