



DOCKLANDS, VIC

90 South Wharf Drive

4 BED **3** BATH **3** CAR



Riverside residence with a brilliant northern orientation

With a stunning location right alongside the river and offering three levels of outstanding north-facing living which also promises 3 separate outdoor areas, this elegant and sophisticated 4 bedroom, 3.5 bathroom, 3 car space residence is a Docklands townhouse to savour.

- ? Developed and built by Mirvac and first time on offer
- ? Ground floor includes an ultra-generous studio living or potential home office which has separate entry to the main residence with exclusive access to its own stylish bathroom
- ? Free-flowing first floor lounge and dining zone accesses 2 fantastic north-facing balconies for hours of alfresco fun!
- ? Well-designed kitchen is functional and showcases premium stone, an island bench, and stainless steel appliances

\$1,950,000 - \$2,000,000

Contact: Baden Lucas
03 9645 1199
0418 888 751

Type: Townhouse

Sold Date: 14/05/2020

<https://www.resbymirvac.com>

90 SOUTH WHARF DRIVE, DOCKLANDS



This floorplan is an artist's impression only, it contains information that we believe to be reliable however we cannot guarantee and accept no responsibility for the accuracy of information supplied. All dimensions are indicative and listed in metres. Interested parties should take their own measurements or engage the services of a licensed surveyor.

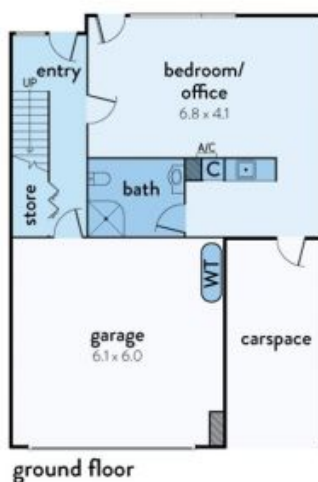
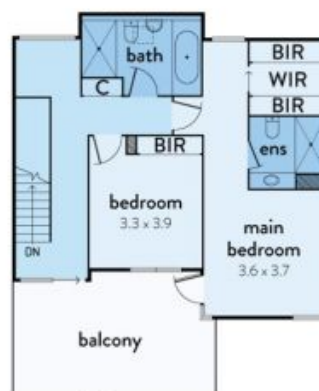

Plans shown are only indicative of layout. Dimensions are approximate.

DOCKLANDS, VIC
90 South Wharf Drive