

EAST MELBOURNE, VIC
602/296 Victoria Parade

1 BED **1** BATH **1** CAR



The Eastbourne - Brand new 1 Bedroom Apartment plus study

Photos shown are of a similar apartment. Colour scheme may vary.

Be the first to call this Eastbourne apartment home!

Eastbourne is set to be an inner-city Eden, a heartbeat from the city, yet feeling like a million miles away. Located in East Melbourne, a neighbourhood of distinction, steeped in history and home to a privileged few.

Apartment features:

- ? Bespoke design, quality construction and finishes
- ? Internal space of 62m2

Under Offer

Contact: Baden Lucas
03 9645 1199
0418 888 751

Type: Apartment

Date Available: 18/10/2019

Leased Date: 22/10/2019

Bond: \$3900

<https://www.resbymirvac.com>



LEVEL 6V

APT 6-02V

LOCATION PLAN

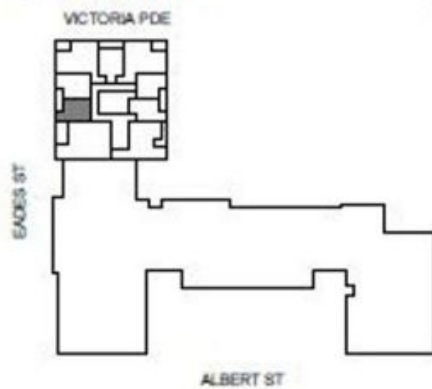

APARTMENT
1 BED 1 BATH + STUDY



Internal Area 62m²

Balcony Area 6m²

Total Area 68m²

Areas subject to final survey, area includes balcony and/or terrace where applicable. It excludes parking and external storage areas.

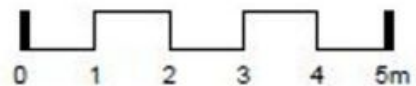

Plans shown are only indicative of layout. Dimensions are approximate.

EAST MELBOURNE, VIC
602/296 Victoria Parade