

**GLEBE, NSW**  
417/131 Ross Street

**2** BED **2** BATH **1** CAR 

**Deposit Taken**

- This 116sqm, 4th floor Apartment offers:
- Oversized 2-Bedroom Apartment in Harold Park
  - Spacious bedrooms with built-in wardrobes
  - Stone benchtops and Miele appliances in kitchen
  - Open-plan living and dining area
  - Sunny balcony with park views
  - Rare 2nd balcony off bedrooms
  - Ultramodern bathrooms with plenty of storage, bath in ensuite
  - Internal laundry with washer and dryer included
  - Secure car space and storage cage included
  - Ducted A/C, video intercom and NBN connectivity
  - 300m to the Heritage-listed Tramsheds, light rail station and public transport

**Deposit Taken**

**Contact:** Matthew Matthews  
02 8588 8888  
0418 266 590  
Stuart Nohra  
02 8588 8888  
0432 206 000

**Type:** Apartment

**Date Available:** 02/11/2019

**Bond:** \$3600

<https://www.resbymirvac.com>

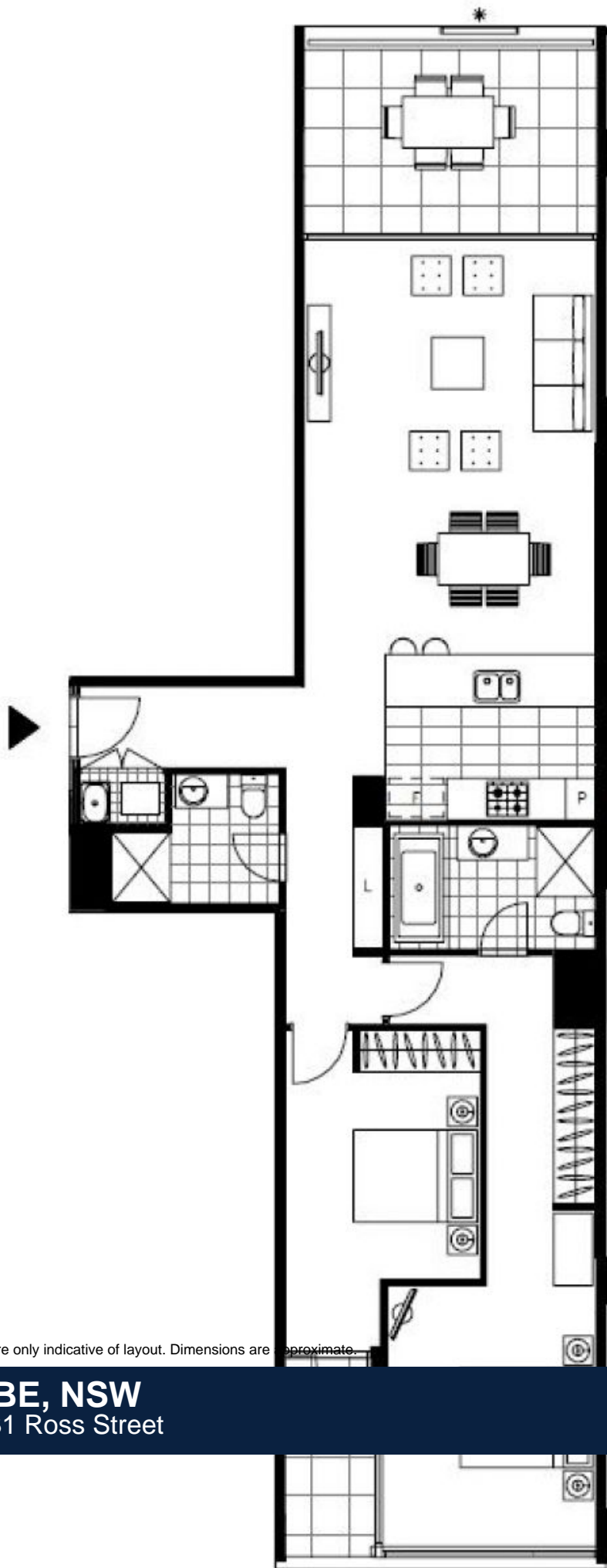

Plans shown are only indicative of layout. Dimensions are approximate.

**GLEBE, NSW**  
417/131 Ross Street