



DOCKLANDS, VIC

1405/1 Point Park Crescent

3
BED

2
BATH

2
CAR



Incredible space, breathtaking views, exceptional location!

Enjoying 142 sqm (approx.) + 15 sqm of unbelievable space which includes two relaxed outdoor areas, this sophisticated and utterly luxurious 3 bedroom + study, 2 bathroom, 2 car space corner apartment is marvellous Yarra's Edge living with views that truly inspire.

- ? Memorable corner position allows for wonderful views which include the iconic CBD, Yarra River and marina, and Port Phillip Bay
- ? Immense living and dining zone allows you to bask in the views while enjoying access out to a sizeable undercover balcony for summer meals
- ? Generous master bedroom boasts large built-in robes, double vanity spa ensuite, and private balcony with amazing views
- ? Impeccable stone and timber veneer kitchen enjoys a long island bench, stainless steel Miele appliances, and integrated fridge and freezer

\$1,250,000 - \$1,325,000

Contact: Baden Lucas
03 9645 1199
0418 888 751
Baden Lucas
03 9645 1199
0418 888 751

Type: Apartment

Sold Date: 29/10/2019

<https://www.resbymirvac.com>

1405/1 POINT PARK CRESCENT, DOCKLANDS



This floorplan is an artist's impression only, it contains information that we believe to be reliable however we cannot guarantee and accept no responsibility for the accuracy of information supplied. All dimensions are indicative and listed in metres. Interested parties should take their own measurements or engage the services of a licensed surveyor.

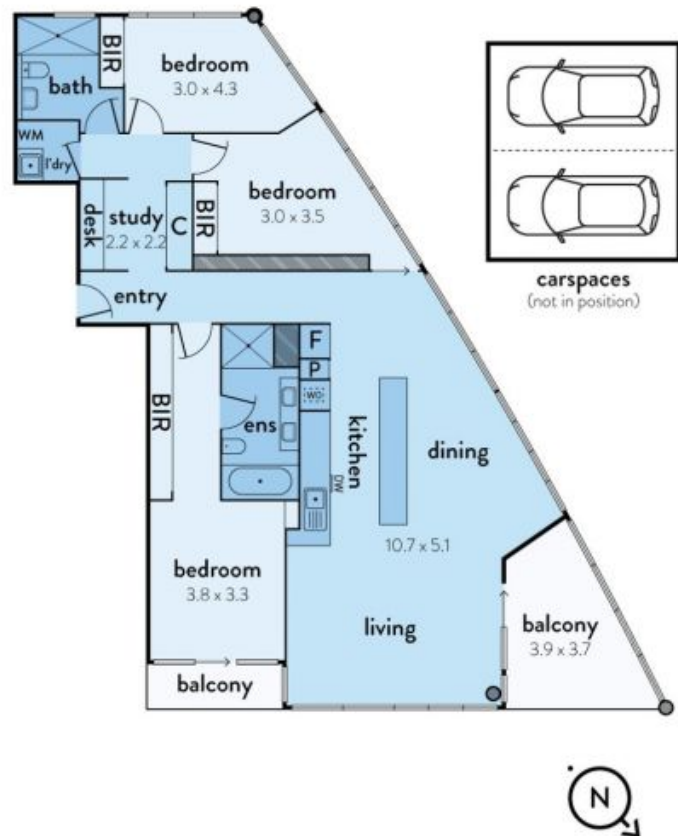

Plans shown are only indicative of layout. Dimensions are approximate.

DOCKLANDS, VIC
1405/1 Point Park Crescent