



DOCKLANDS, VIC

2506/50 Lorimer Street

2 BED **1** BATH **1** CAR 

Incredible water views and stylish renovated touches

With the breathtaking Yarra River and Port Phillip Bay as your daily backdrop, and delivering a floorplan that places a premium on open and relaxed living, this renovated 2 bedroom Yarra's Edge treasure is an elegant and sophisticated prize.

- ? Enjoy a brilliant corner position which allows for unforgettable bay and river vistas
- ? Completely refurbished kitchen includes stylish floor tiles, stone surfaces, added island bench, and premium stainless steel appliances
- ? Other updated touches include designer lighting and blackout blinds
- ? Open plan central living and meals offers bright floor-to-ceiling windows allowing for superb light and views
- ? Both bedrooms with BIR storage, one bedroom has access to a private west-facing balcony

\$690,000 - \$740,000

Contact: Baden Lucas
03 9645 1199
0418 888 751

Type: Apartment

Sold Date: 22/08/2019

<https://www.resbymirvac.com>

2506/50 LORIMER STREET, DOCKLANDS

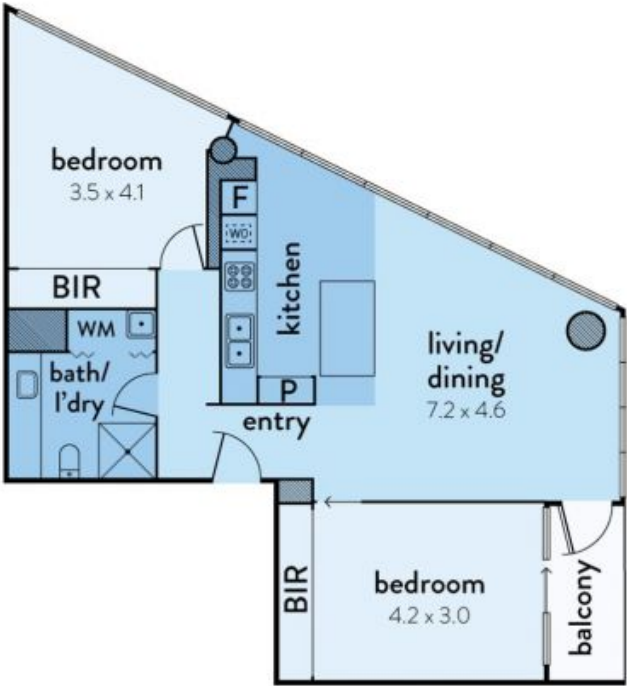

This floorplan is an artist's impression only, it contains information that we believe to be reliable however we cannot guarantee and accept no responsibility for the accuracy of information supplied. All dimensions are indicative and listed in metres. Interested parties should take their own measurements or engage the services of a licensed surveyor.

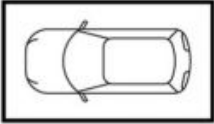

carspace
(not in position)



Plans shown are only indicative of layout. Dimensions are approximate.