



## EAST MELBOURNE, VIC

604/280 Albert Street

**2**  
BED

**2**  
BATH

**1**  
CAR



### The Eastbourne ? 2 bedroom - 2 bathroom - park views ? this is living!

Be the first to occupy this stunning 2-bedroom, 2-bathroom apartment.

Eastbourne offers exemplary living with a refreshing approach to providing genuinely considered and spacious living. The fortunate residents are surrounded by lush Fitzroy Gardens, and the CBD is only a 5 minute tram ride away.

Resident facilities are second-to-none ? see offerings below.

Apartment features:

? Bespoke design, quality construction and finishes

? Internal space of 120m2

**\$950 per week**

**Contact:** Baden Lucas  
03 9645 1199  
0418 888 751

**Type:** Apartment

**Date Available:** 02/09/2019

**Leased Date:** 07/10/2019

**Bond:** \$5700

<https://www.resbymirvac.com>



LEVEL 6

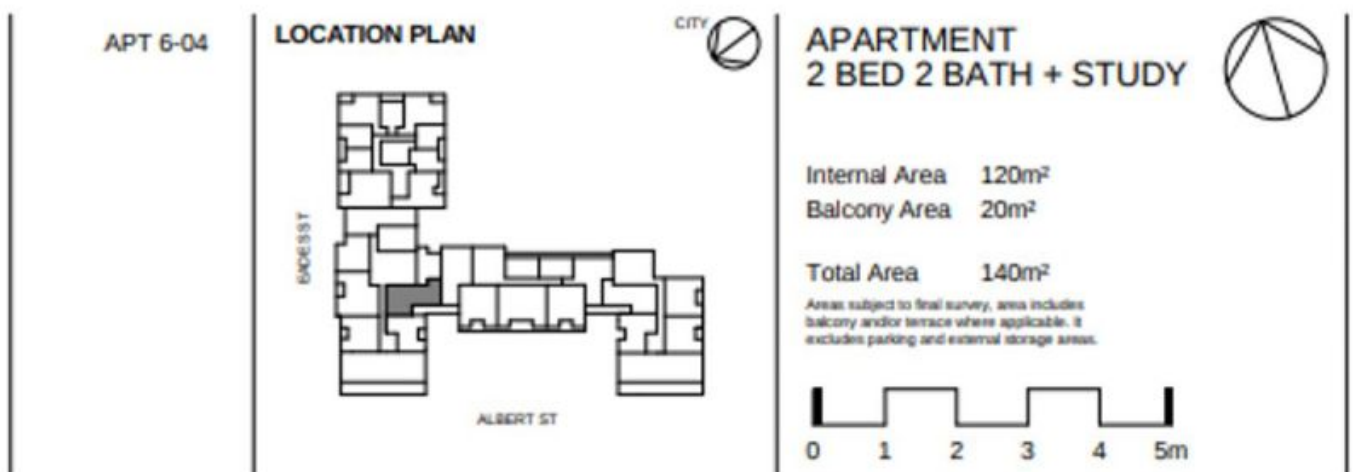

Plans shown are only indicative of layout. Dimensions are approximate.

**EAST MELBOURNE, VIC**  
604/280 Albert Street