



DONCASTER, VIC

121/65 Stables Circuit

2
BED

1
BATH

1
CAR



2-bedroom apartment with 33m2 outdoor terrace!

This Phoenix apartment is set to elevate the lifestyle of its tenant.

With lush parklands at its doorstep; where style, privacy and timeless design blends with nature, beauty and freedom. Unique, exclusive and limited, this is a lifestyle of distinction.

Apartment features:

- ? Bespoke design, quality construction and finishes
- ? Large internal space of 72m2
- ? Balcony ? 33m2 ? overlooking park

\$450 per week

Contact: Baden Lucas
03 9645 1199
0418 888 751

Type: Apartment

Date Available: 16/07/2019

Leased Date: 20/09/2019

Bond: \$2700

<https://www.resbymirvac.com>



LEVEL 01



APT 1.21

LOCATION PLAN

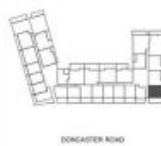

APARTMENT TYPE
2 BED, 1 BATH

INTERNAL AREA 72 m²
BALCONY AREA 33 m²
TOTAL AREA 105 m²

Areas subject to final set out, area includes balcony, parking and external storage areas.

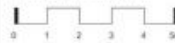

IMPORTANT NOTICE
Please note that this floor plan was produced prior to construction. Changes will inevitably be made during development and subject to change without notice in accordance with the provisions of the contract for sale. The information contained herein is intended to be a general guide only and is not intended to be a representation of the final product. Prospective purchasers must refer to the contract for sale for the full of conditions. All graphics, including the layout, landscaping, planting, lighting and sun-shading screens, are intended as a guide only and are not to be relied on as a representation of the final product.

FINISHES

2 ADHESIVE UNIT

1.1 IN SOLID FRAMING SCREEN

CONTACT NUMBER:

02 9666 1666

APARTMENTS OF TULLAMORE WEBSITE:

www.apartmentsof.tullamore.com

FEATURE LAYOUT:



Plans shown are only indicative of layout. Dimensions are approximate.

DONCASTER, VIC
121/65 Stables Circuit