



DONCASTER, VIC
G02/65 Stables Circuit

2 BED **2** BATH **2** CAR



2-bedroom corner apartment with very large courtyard

Be the first to live in Phoenix apartment - with lush parkland on its doorstep; where style, privacy and timeless design blends with nature, beauty and freedom. Unique, exclusive and limited, this is a lifestyle of distinction.

Apartment features:

- ? Bespoke design, quality construction and finishes
- ? Large internal space of 88m²
- ? Balcony ? 53m² ? overlooking park
- ? Storage cage near car spaces
- ? X2 car spaces, side-by-side
- ? Ducted heating & refrigerated cooling throughout
- ? Timber flooring to kitchen and living areas

\$560 per week

Contact: Baden Lucas
03 9645 1199
0418 888 751

Type: Apartment

Date Available: 01/07/2019

Leased Date: 08/07/2019

Bond: \$3360

<https://www.resbymirvac.com>



GROUND FLOOR

APT G.02

LOCATION PLAN



APARTMENT TYPE
2 BED, 2 BATH + STUDY

Plans shown are only indicative of layout. Dimensions are approximate.

INTERNAL AREA 88 m²
BALCONY AREA 53 m²

DONCASTER, VIC
G02/65 Stables Circuit

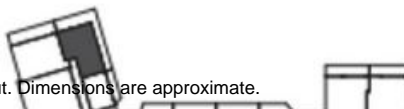

DONCASTER ROAD

excludes parking and external storage areas.

