

## EAST MELBOURNE, VIC

605/296 Victoria Parade

**1** BED **1** BATH **1** CAR



### The Eastbourne - 1-bedroom apartment ? Beautiful Treetop Views

Be the first to call The Eastbourne home!

Eastbourne is set to be an inner-city Eden, a heartbeat from the city, yet feeling like a million miles away. Located in East Melbourne, a neighbourhood of distinction, steeped in history and home to a privileged few.

Apartment features:

- ? Bespoke design, quality construction and finishes
- ? Internal space of 59m2
- ? Large balcony ? 13m2
- ? X1 Car space

**\$600 per week**

**Contact:** Baden Lucas  
03 9645 1199  
0418 888 751

**Type:** Apartment

**Date Available:** 01/07/2019

**Leased Date:** 24/08/2019

**Bond:** \$2607

<https://www.resbymirvac.com>

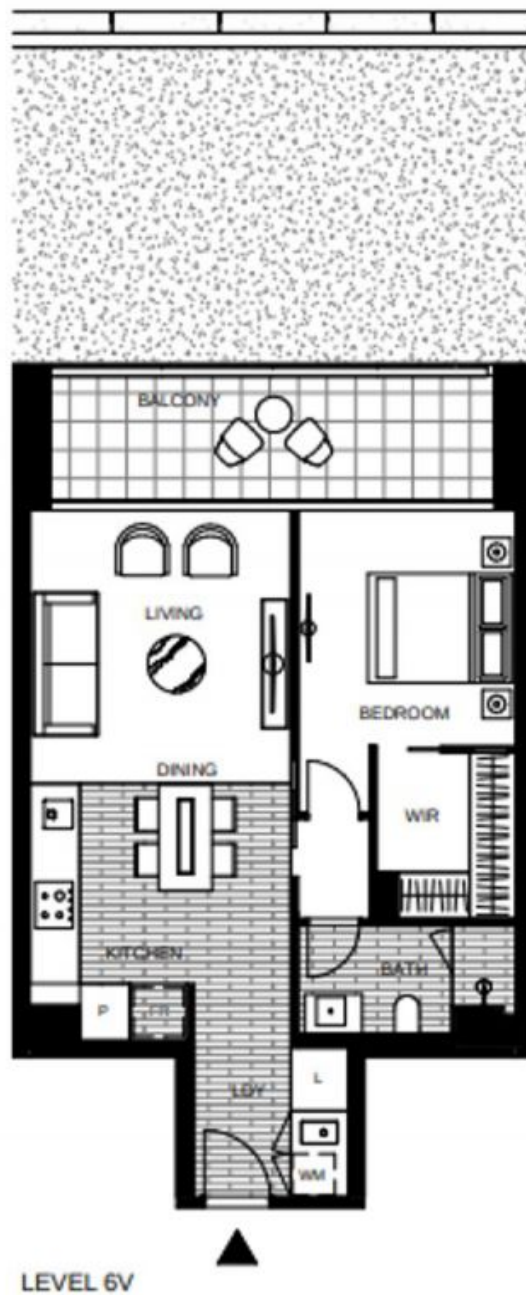

APT 6-05V

# LOCATION PLAN

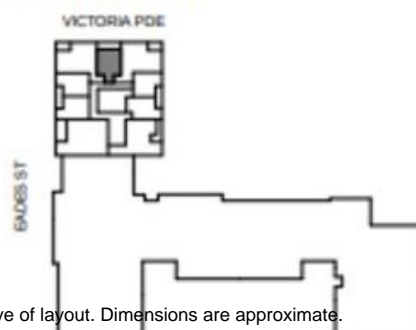

## APARTMENT 1 BED 1 BATH



Internal Area 59m<sup>2</sup>

Balcony Area 13m<sup>2</sup>

Total Area 72m<sup>2</sup>

Areas subject to final survey; area includes balcony and/or terrace where applicable. It excludes parking and external storage areas.

Plans shown are only indicative of layout. Dimensions are approximate.

**EAST MELBOURNE, VIC**  
605/296 Victoria Parade