



**DOCKLANDS, VIC**  
502/98 River Esplanade

**2** BED **1** BATH **1** CAR



**Experience waterside excellence with this 5th floor podium beauty!**

Some of the best waterside living you're likely to find in the Docklands which delivers exceptional northern views of the marina along with a style and comfort on this top floor podium level is hard to beat, this 2 bedroom residence is your next Yarra's Edge home.

- ? Enjoy the charming 5th floor location and terrific northern orientation
- ? Tasmanian Oak timber floors through much of the apartment adds a touch of class
- ? Open and generous central lounge and meals zones for everyday living
- ? Balcony has 3 entry points and fantastic northern views
- ? State of the art kitchen enjoys tiered island bench, glass splashback, and s/steel appliances

**\$700,000 - \$750,000**

**Contact:** Baden Lucas  
03 9645 1199  
0418 888 751

**Type:** Apartment

**Sold Date:** 11/07/2019

<https://www.resbymirvac.com>

# 502/98 RIVER ESPLANADE, DOCKLANDS

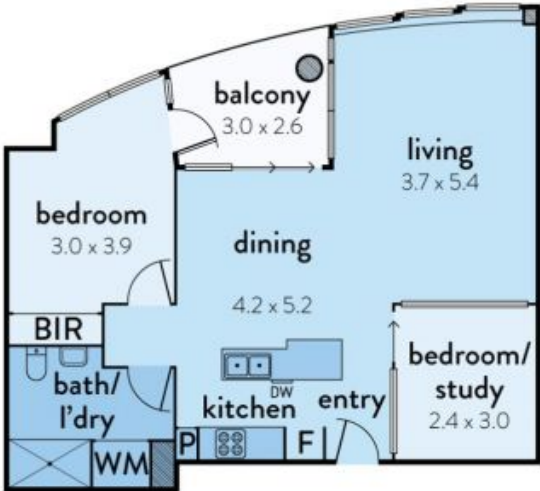

This floorplan is an artist's impression only, it contains information that we believe to be reliable however we cannot guarantee and accept no responsibility for the accuracy of information supplied. All dimensions are indicative and listed in metres. Interested parties should take their own measurements or engage the services of a licensed surveyor.

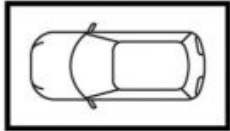

**carspace**  
(not in position)



**storage cage**  
(not in position)



Plans shown are only indicative of layout. Dimensions are approximate.

**DOCKLANDS, VIC**  
502/98 River Esplanade