



## DOCKLANDS, VIC

2704/1 Point Park Crescent

3  
BED

2  
BATH

2  
CAR



### The ultimate Yarra's Edge prize with breathtaking views

The epitome of effortless and luxurious Yarra's Edge living which promises breathtaking views that won't soon be forgotten, this stunningly immaculate 3 bedroom + study, 2 bathroom, 2 car space residence is in a league of its own.

? On the 27th floor of Yarra Point which allows for views of Port Phillip Bay, Yarra River, north and west mountain ranges, and iconic CBD skyline

? Generous central lounge and dining is saturated in natural light thanks to bright full windows

? State of the art kitchen with integrated fridge and freezer, a wealth of storage options, Zip hydrotap, Vintec wine fridge, and full Miele appliances including a steam oven and built-in Nespresso coffee maker

**\$1,300,000 - \$1,395,000**

**Contact:** Baden Lucas  
03 9645 1199  
0418 888 751

**Type:** Apartment

**Sold Date:** 19/08/2019

<https://www.resbymirvac.com>

# 2704/1 POINT PARK CRESCENT, DOCKLANDS



This floorplan is an artist's impression only, it contains information that we believe to be reliable however we cannot guarantee and accept no responsibility for the accuracy of information supplied. All dimensions are indicative and listed in metres. Interested parties should take their own measurements or engage the services of a licensed surveyor.

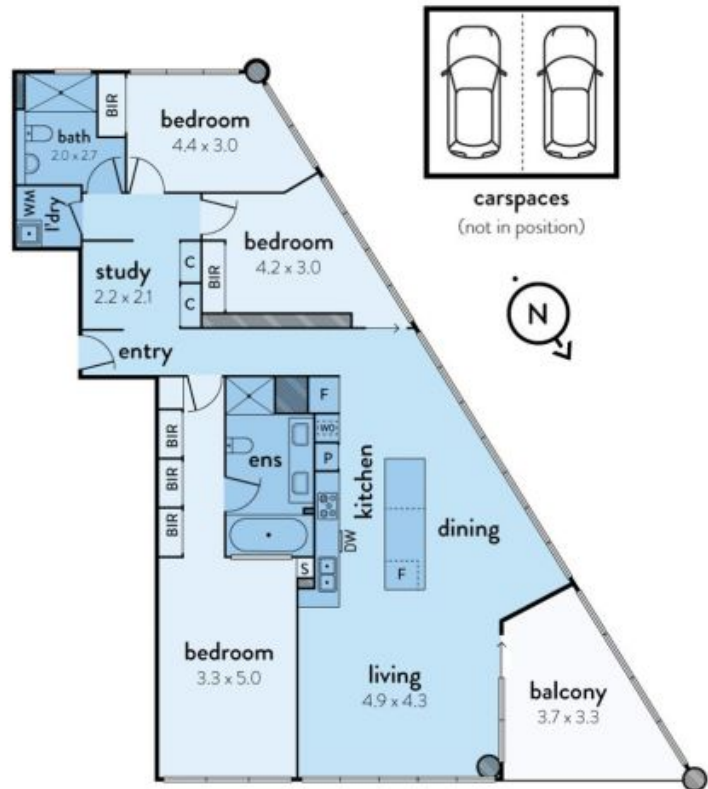

Plans shown are only indicative of layout. Dimensions are approximate.

**DOCKLANDS, VIC**  
2704/1 Point Park Crescent