



DOCKLANDS, VIC
2801/80 Lorimer Street

4 BED **2** BATH **3** CAR



Sub-penthouse stunner with exceptional views and amazing space

With stunning views from all rooms, an incredible amount of internal space, and enviable modern luxury, this 4 bedroom, 2.5 bathroom sub-penthouse apartment is out of this world!

- ? On the private and peaceful 28th floor with only two other apartments on the level
- ? Enjoy 176 sqm (approx.) of internal space
- ? Views include Port Phillip Bay, Yarra River, mountain ranges to the north, and the iconic CBD
- ? Expansive lounge and dining enjoys brilliant light and the superb views through full windows
- ? Stone kitchen has integrated fridge and freezer plus full Miele appliances including a coffee machine

\$1,600,000 - \$1,700,000

Contact: Baden Lucas
03 9645 1199
0418 888 751

Type: Apartment

Sold Date: 03/03/2020

<https://www.resbymirvac.com>

2801/80 LORIMER STREET, DOCKLANDS



This floorplan is an artist's impression only, it contains information that we believe to be reliable however we cannot guarantee and accept no responsibility for the accuracy of information supplied. All dimensions are indicative and listed in metres. Interested parties should take their own measurements or engage the services of a licensed surveyor.

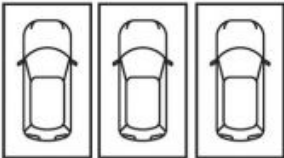
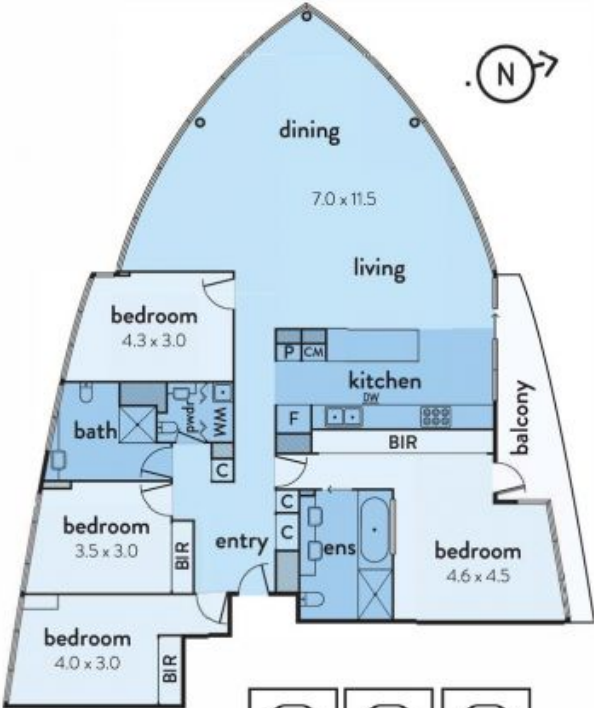

carspace
(not in position)

Plans shown are only indicative of layout. Dimensions are approximate.